

MUNICIPALITY OF MONTICELLO

PREPARED BY THE
MINNESOTA DEPARTMENT OF TRANSPORTATION
OFFICE OF TRANSPORTATION SYSTEM MANAGEMENT

IN COOPERATION WITH
U.S. DEPARTMENT OF TRANSPORTATION
FEDERAL HIGHWAY ADMINISTRATION

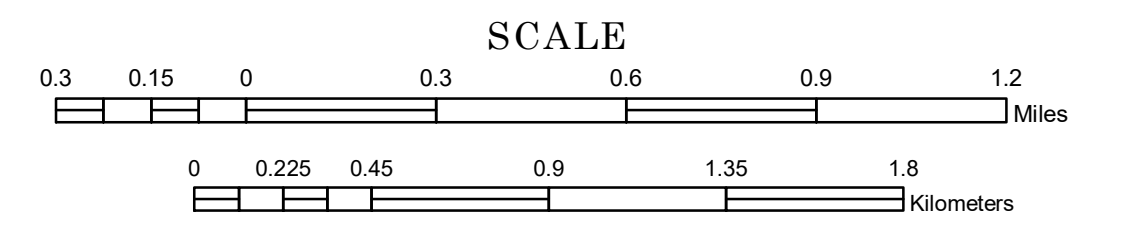

1 in = 1,600 ft
2019

Projection:
Transverse Mercator
NAD 1986
UTM Zone 15

North American Datum
of 1986

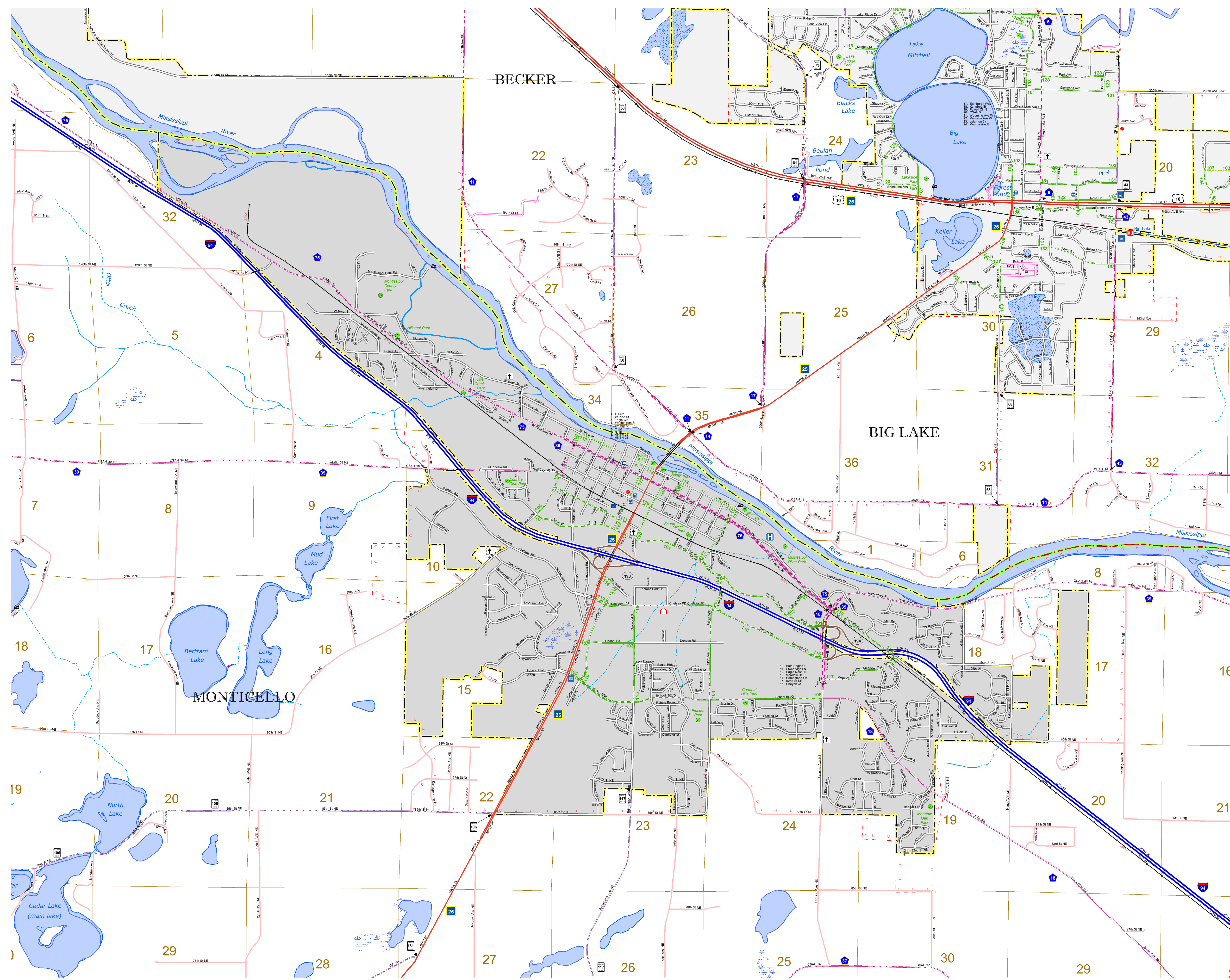

ROAD AND ROADWAY FEATURES		PUBLIC SERVICE FEATURES	
INTERSTATE		MNDOT OFFICE	
US HIGHWAY		MNDOT TRUCK STATION	
MN HIGHWAY		HIGHWAY PATROL DISTRICT OFFICE	
COUNTY STATE AID HIGHWAY		STATE TRAVEL INFORMATION CENTER	
COUNTY ROAD		REST AREA (FULL SERVICE)	
MUNICIPAL STATE AID STREET		REST AREA (VAULT TOLL)	
PRIVATE STREET/ROAD		WAYSIDE (DAILY OR PIT TOILET)	
TOWNSHIP ROAD		LOCAL PARK	
UNORGANIZED TERRITORY ROAD		PUBLIC ACCESS POINT	
RAMP OR CONNECTOR		FARMGROUNDS	
INTERSTATE EXIT		PORT OF ENTRY	
GREAT RIVER ROAD		PARK AND RIDE LOT	
OTHER ROADS		PUBLIC UNIVERSITY/COLLEGE	
FRONTAGE		PRIVATE UNIVERSITY/COLLEGE	
STATE PARK			
NATIONAL PARK			
NATIONAL MONUMENT			
STATE FOREST			
NATIONAL FOREST			
NATIONAL WILDLIFE STATE GAME			
AVIATION FEATURES			
COMMERCIAL AIRPORT			
GENERAL AIRPORT			
AIRSTRIP			
SEAPLANE			
AIRPORT RUNWAY			
RAILWAY			
EMPIRE BUILDER STATION (AMTRAK)			
NORTHSTAR STATION (COMMUTER)			
LIGHT RAIL			
BLUE LINE			
GREEN LINE			
INFRASTRUCTURE FEATURES			
LONG BRIDGE (100' OR GREATER SPAN)			
MAJOR BRIDGE (20' TO 100' SPAN)			
MINOR BRIDGE (5' TO 20' SPAN)			
DAM			
LOCK AND DAM			
PUBLIC FACILITIES			
STATE CAPITOL			
FEDERAL COURTHOUSE			
COUNTY COURTHOUSE			
ARMORY			
CITY CENTERS			
TRIBAL GOVERNMENT CENTER			
CITY CENTER			
LOCALLY KNOWN PLACE			
UNINCORPORATED COMMUNITY			
WETLAND			
ISLAND OR LAND			
REGIONAL WATERSHED			

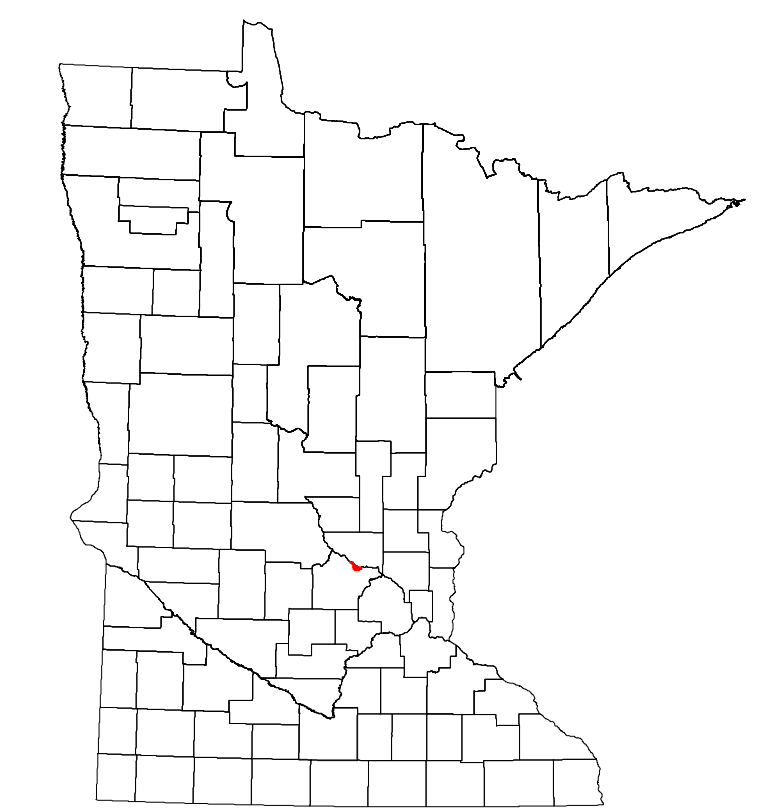

Population (U.S. Census 2010): 12759

To request information from this document in an alternative format, call 651-366-4718 or 1-800-657-3774 (Greater Minnesota); 711 or 1-800-627-3529 (Minnesota Relay). You may also send an e-mail to ADArequest.dot@state.mn.us. (Please request at least one week in advance.)