

MUNICIPALITY OF NORTHFIELD

PREPARED BY THE
MINNESOTA DEPARTMENT OF TRANSPORTATION
OFFICE OF TRANSPORTATION SYSTEM MANAGEMENT
IN COOPERATION WITH
U.S. DEPARTMENT OF TRANSPORTATION
FEDERAL HIGHWAY ADMINISTRATION

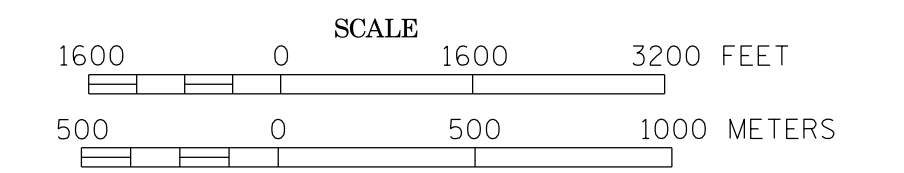

BASIC DATA - 2013

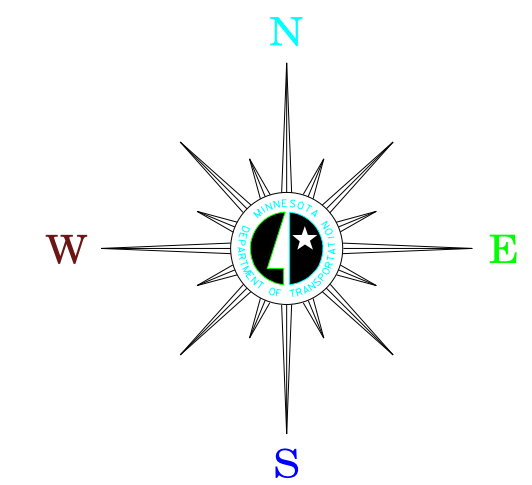

LEGEND

- INTERSTATE TRUNK HIGHWAY..... (35)
- U.S. TRUNK HIGHWAY..... (10)
- STATE TRUNK HIGHWAY..... (55)
- COUNTY STATE AID HIGHWAY..... (23)
- COUNTY ROAD..... (19)
- CORPORATE LIMITS.....
- PUBLIC ROAD.....
- PRIVATE ROAD.....

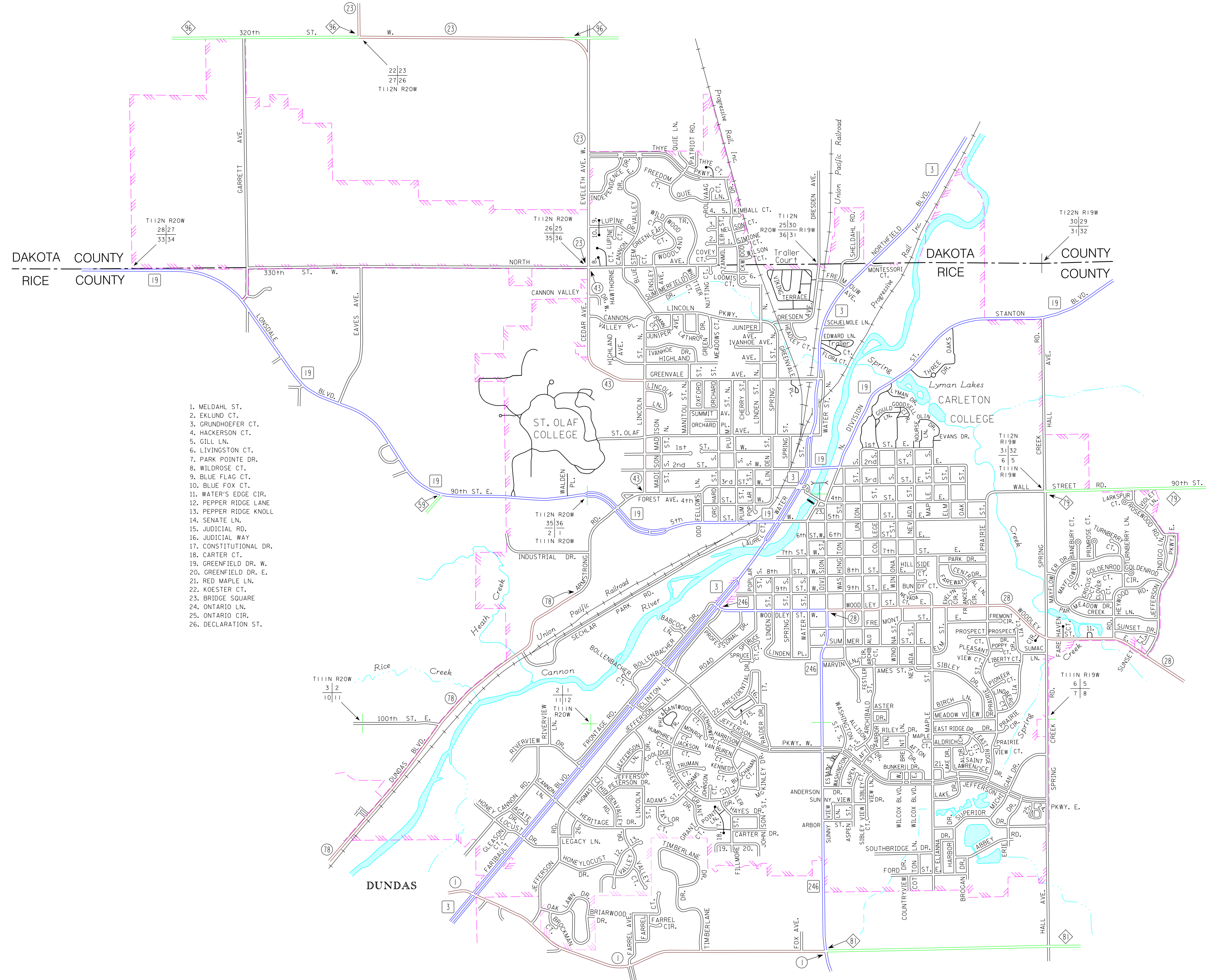

1. MELDAR ST.
2. ESKIND CT.
3. GRUNDHEFER CT.
4. HACKERSON CT.
5. GILL LN.
6. LIVINGSTON CT.
7. PARK POINTE DR.
8. WILDROSE CT.
9. BLUE FLAG CT.
10. BLUE FOX CT.
11. WATER'S EDGE CIR.
12. PEPPER RIDGE LANE
13. PEPPER RIDGE KNOLL
14. SENKIE LN.
15. JUDICIAL RD.
16. CONSTITUTIONAL DR.
17. CARTER CT.
18. GREENFIELD DR. W.
19. GREENFIELD DR. E.
20. RED MAPLE LN.
21. KOESTER CT.
22. BRIDGE SQUARE
23. ONTARIO LN.
24. ONTARIO CIR.
25. DECLARATION ST.

To request information from this document in an alternative format, call 651-366-4718 or 1-800-457-3774 (Greater Minnesota), 711 or 1-800-627-3529 (Minnesota Relay). You may also send an e-mail to ADArequest.dot@state.mn.us. (Please request at least one week in advance).