

# TOWNSHIP OF RUNEBERG

PREPARED BY THE  
MINNESOTA DEPARTMENT OF TRANSPORTATION  
OFFICE OF TRANSPORTATION SYSTEM MANAGEMENT

IN COOPERATION WITH  
U.S. DEPARTMENT OF TRANSPORTATION  
FEDERAL HIGHWAY ADMINISTRATION

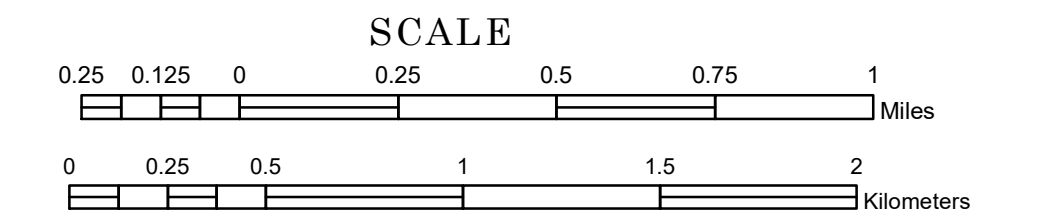

2022

Projection:  
Transverse Mercator  
NAD 1986  
UTM Zone 15

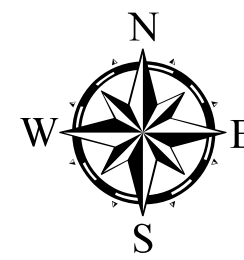

North American Datum  
of 1986

ROAD AND ROADWAY FEATURES		BOUNDARY FEATURES	
INTERSTATE	CONCRETE	TRIAL LAND	TRIBAL LAND
US HIGHWAY	BITUMINOUS	STATE OF MINNESOTA	COUNTY
MN HIGHWAY	GRAVEL	MUNICIPALITY	MUNICIPALITY
COUNTY STATE AID HIGHWAY	DIRT/UNIMPROVED	UNINCORPORATED TOWNSHIP	CIVIL TOWNSHIP
COUNTY ROAD	OTHER	CONGRESSIONAL TOWNSHIP	SECTION
TOWNSHIP ROAD	UNKNOWN	MILITARY	MILITARY
UNORGANIZED TERRITORY ROAD		VOYAGEURS NATIONAL PARK	VOYAGEURS NATIONAL PARK
OTHER ROADS		BOUNDARY WATERS CANOE AREA WILDERNESS	STATE PARK
Municipal	RAMP OR CONNECTOR	REGIONAL PARK	REGIONAL PARK
Private	INTERSTATE EXIT	NATIONAL FOREST	NATIONAL FOREST
National Monument	GREAT RIVER ROAD	NATIONAL AND STATE FOREST	NATIONAL AND STATE FOREST
National Wildlife Refuge	AVIATION FEATURES	STATE FOREST	STATE FOREST
State Game Preserve	COMMERCIAL AIRPORT	WILDLIFE REFUGE AREA	WILDLIFE REFUGE AREA
State Park	GENERAL AIRPORT	WILDLIFE MANAGEMENT AREA	WILDLIFE MANAGEMENT AREA
Preserve	AIRSTRIP	HYDROLOGIC FEATURES	HYDROLOGIC FEATURES
	SEAPLANE	RIVER OR STREAM (PERMANENT)	RIVER OR STREAM (PERMANENT)
	AIRPORT RUNWAY	LAKE, POND OR RESERVOIR	LAKE, POND OR RESERVOIR
		STREAM (INTERMITTENT)	STREAM (INTERMITTENT)
		DRAINAGE DITCH	DRAINAGE DITCH
		WETLAND	WETLAND
		ISLAND OR LAND	ISLAND OR LAND
		REGIONAL WATERSHED	REGIONAL WATERSHED

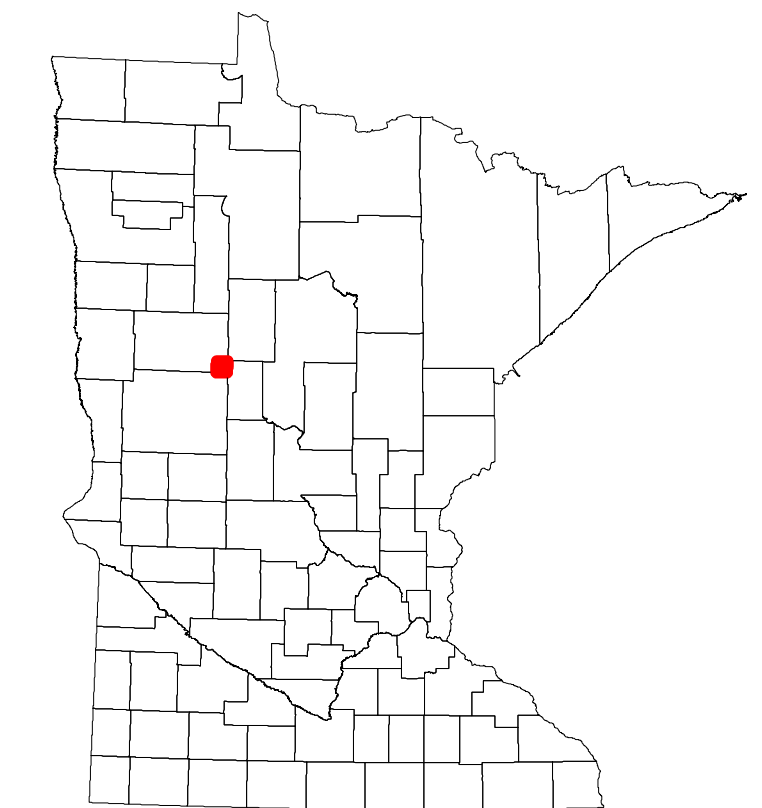

Population (U.S. Census 2010): 486

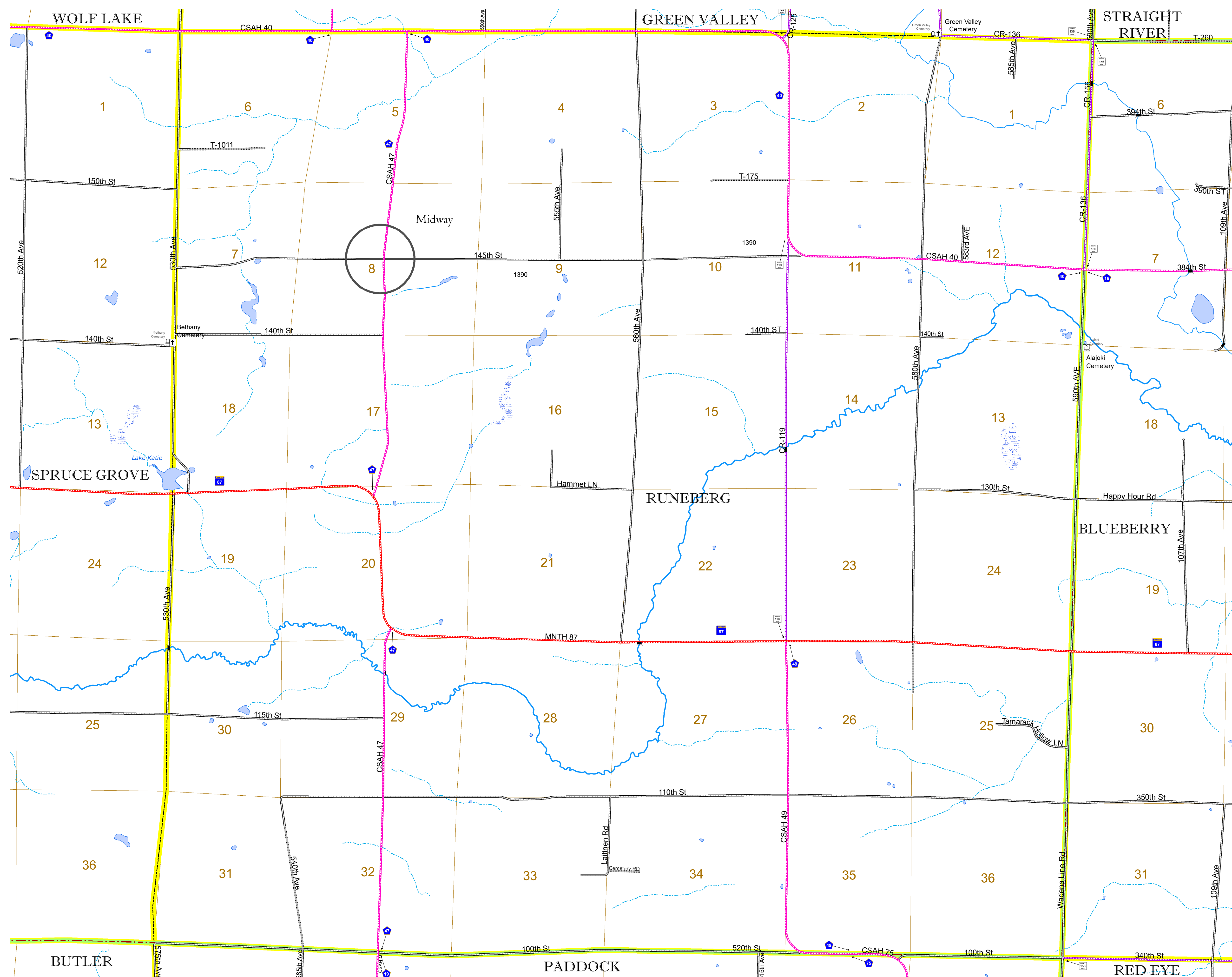

To request information from this document in an alternative format, call 651-366-4718 or 1-800-657-3774 (Greater Minnesota); 711 or 1-800-627-3529 (Minnesota Relay). You may also send an e-mail to ADarequest.dot@state.mn.us. (Please request at least one week in advance.)