

TOWNSHIP OF BEMIDJI

PREPARED BY THE
MINNESOTA DEPARTMENT OF TRANSPORTATION
OFFICE OF TRANSPORTATION SYSTEM MANAGEMENT

IN COOPERATION WITH
U.S. DEPARTMENT OF TRANSPORTATION
FEDERAL HIGHWAY ADMINISTRATION



1 in = 1,600 ft

2022

Projection:
Transverse Mercator
NAD 1986
UTM Zone 15



North American Datum
of 1986

ROAD AND ROADWAY FEATURES		AVIATION FEATURES	
INTERSTATE		CONCRETE	
US HIGHWAY		BITUMINOUS	
MN HIGHWAY		GRAVEL	
COUNTY STATE AID HIGHWAY		DIRT/UNIMPROVED	
COUNTY ROAD		OTHER	
TOWNSHIP ROAD		UNKNOWN	
UNORGANIZED TERRITORY ROAD			
OTHER ROADS		RAMP OR CONNECTOR	
Municipal		INTERSTATE EXIT	
Private		GREAT RIVER ROAD	
National Monument			
State Forest			
Nature Service			
National Park			
National Wildlife			
State Game			
Military			
State Park			
Preserve			
RAILROAD AND RAILWAY FEATURES		BOUNDARY FEATURES	
EMPIRE BUILDER STATION (AMTRAK)		TRIBAL LAND	
NORTHSTAR STATION (COMPUTER)		STATE OF MINNESOTA	
SEAPLANE		COUNTY	
AIRSTRIP		MUNICIPALITY	
GENERAL AIRPORT		UNORGANIZED TERRITORY	
COMMERCIAL AIRPORT		FEDERAL ADJUSTED URBAN AREA (2014)	
SEAPLANE		CIVIL TOWNSHIP	
AIRPORT RUNWAY		CONGRESSIONAL TOWNSHIP	
SECTION		MILITARY	
VOYAGEURS NATIONAL PARK		BOUNDRY WATERS CANOE AREA WILDERNESS	
STATE PARK		REGIONAL PARK	
NATIONAL FOREST		NATIONAL AND STATE FOREST	
STATE FOREST		WILDLIFE REFUGUE AREA	
WILDLIFE REFUGUE AREA		WILDLIFE MANAGEMENT AREA	
WILDLIFE MANAGEMENT AREA		HYDROLOGIC FEATURES	
HYDROLOGIC FEATURES		RIVER OR STREAM (PERENNIAL)	
RIVER OR STREAM (PERENNIAL)		LAKE, POND OR RESERVOIR	
LAKE, POND OR RESERVOIR		STREAM (INTERMITTENT)	
STREAM (INTERMITTENT)		DRAINAGE DITCH	
DRAINAGE DITCH		WETLAND	
WETLAND		ISLAND OR LAND	
ISLAND OR LAND		REGIONAL WATERSHED	
REGIONAL WATERSHED			



Population (U.S. Census 2010): 3134

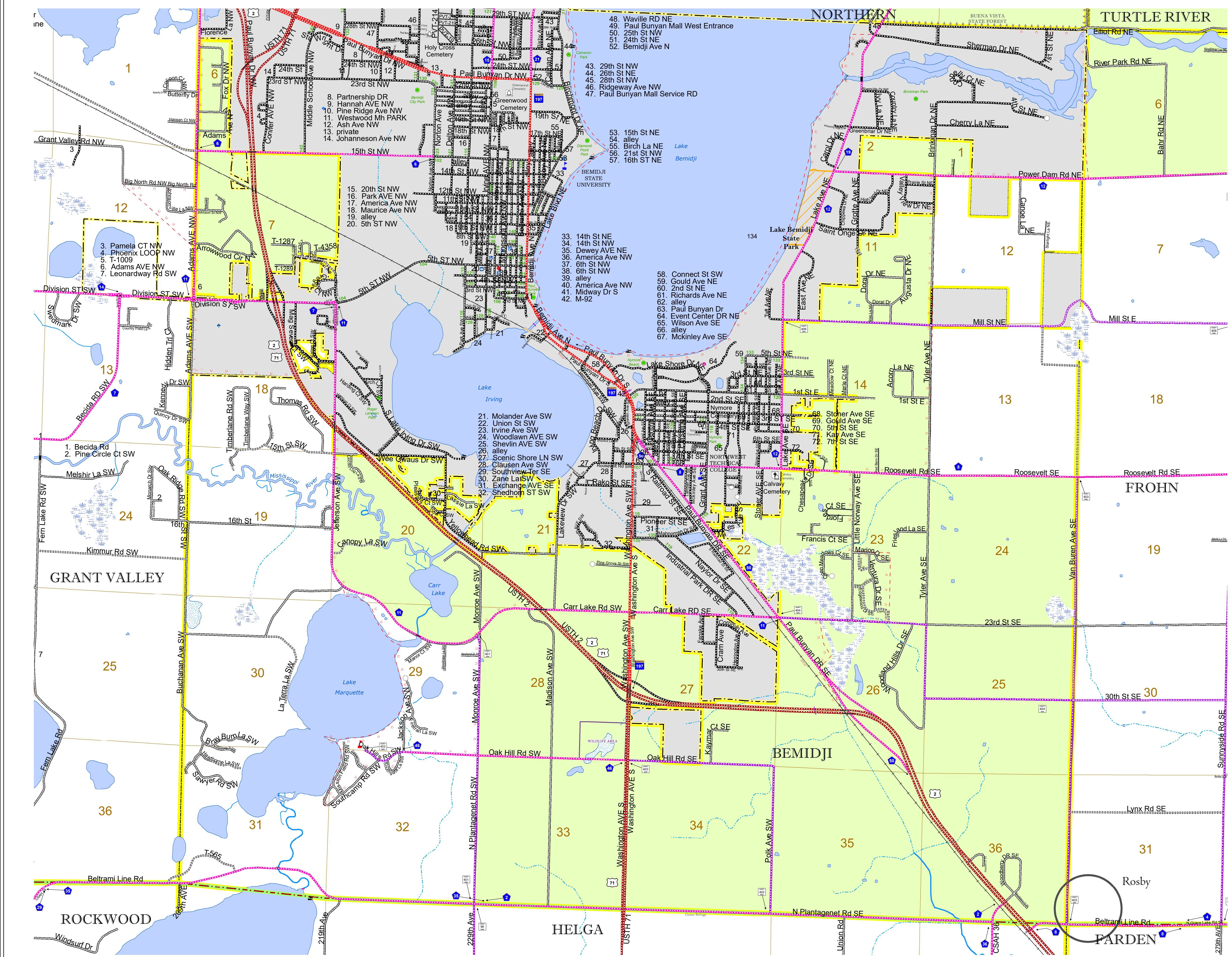

To request information from this document in an alternative format, call 651-366-4718 or 1-800-657-3774 (Greater Minnesota); 711 or 1-800-627-3529 (Minnesota Relay). You may also send an e-mail to ADRequest.dot@state.mn.us. (Please request at least one week in advance.)