

TOWNSHIP OF HAMRE

PREPARED BY THE
MINNESOTA DEPARTMENT OF TRANSPORTATION
OFFICE OF TRANSPORTATION SYSTEM MANAGEMENT

IN COOPERATION WITH
U.S. DEPARTMENT OF TRANSPORTATION
FEDERAL HIGHWAY ADMINISTRATION

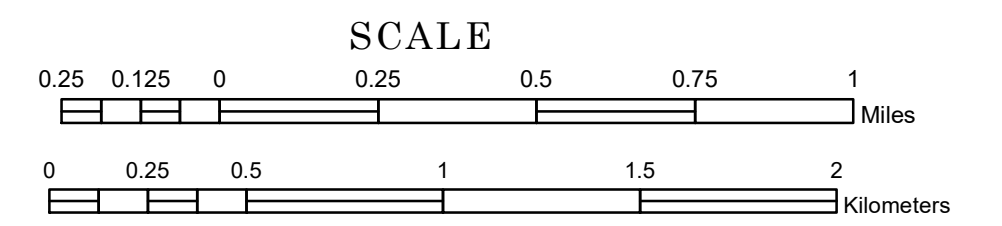

1 in = 1,600 ft
2022

Projection:
Transverse Mercator
NAD 1986
UTM Zone 15

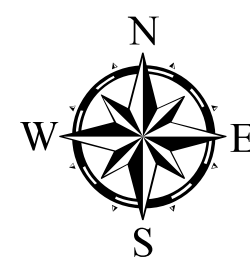

North American Datum
of 1986

ROAD AND ROADWAY FEATURES INTERSTATE: [Symbol] US HIGHWAY: [Symbol] MN HIGHWAY: [Symbol] COUNTY STATE AID HIGHWAY: [Symbol] COUNTY ROAD: [Symbol] TOWNSHIP ROAD: [Symbol] UNORGANIZED TERRITORY ROAD: [Symbol] OTHER ROADS: Municipal: [Symbol] Private: [Symbol] National Monument: [Symbol] National Park: [Symbol] National Wildlife Refuge: [Symbol] State Park: [Symbol] Preserve: [Symbol]		RAILROAD AND RAILWAY FEATURES EMPIRE BUILDER STATION (AMTRAK): [Symbol] NORTHSTAR STATION (COMMUTER): [Symbol] LIGHT RAIL: [Symbol] BLUE LINE: [Symbol] GREEN LINE: [Symbol]		AVIATION FEATURES RAMP OR CONNECTOR: [Symbol] INTERSTATE EXIT: [Symbol] GREAT RIVER ROAD: [Symbol] COMMERCIAL AIRPORT: [Symbol] GENERAL AIRPORT: [Symbol] AIRSTRIP: [Symbol] SEAPLANE: [Symbol] AIRPORT RUNWAY: [Symbol]		BOUNDARY FEATURES TRIBAL LAND: [Symbol] STATE OF MINNESOTA: [Symbol] COUNTY: [Symbol] MUNICIPALITY: [Symbol] UNORGANIZED TERRITORY: [Symbol] FEDERAL ADJUSTED URBAN AREA (2014): [Symbol] CIVIL TOWNSHIP: [Symbol] CONGRESSIONAL TOWNSHIP: [Symbol] SECTION: [Symbol] MILITARY: [Symbol] VOYAGEURS NATIONAL PARK: [Symbol] BOUNDARY WATERS CANOE AREA WILDERNESS: [Symbol] STATE PARK: [Symbol] REGIONAL PARK: [Symbol] NATIONAL FOREST: [Symbol] NATIONAL AND STATE FOREST: [Symbol] STATE FOREST: [Symbol] NATIONAL TRAIL: [Symbol] WILDLIFE REFUGUE AREA: [Symbol] WILDLIFE MANAGEMENT AREA: [Symbol]	
INFRASTRUCTURE FEATURES LONG BRIDGE (200' OR GREATER SPAN): [Symbol] MAJOR BRIDGE (20' TO 200' SPAN): [Symbol] MINOR BRIDGE (5' TO 20' SPAN): [Symbol] DAM: [Symbol] LOCK-AND-DAM: [Symbol]		CITY CENTERS STATE CAPITAL: [Symbol] COUNTY SEAT: [Symbol] CITY CENTER: [Symbol] UNINCORPORATED COMMUNITY: [Symbol]		PUBLIC SERVICE FEATURES MNDOT OFFICE: [Symbol] MNDOT TRUCK STATION: [Symbol] HIGHWAY PATROL DISTRICT OFFICE: [Symbol] STATE TRAVEL INFORMATION CENTER: [Symbol] REST AREA (FULL SERVICE): [Symbol] REST AREA (VAULT TOILET): [Symbol] WAYSIDE (VAULT OR PIT TOILET): [Symbol] PARK AND RIDE LOT: [Symbol] PORT OF ENTRY: [Symbol] PUBLIC ACCESS POINT: [Symbol] MN STATE COLLEGE AND UNIVERSITY SYSTEM (MNSCU): [Symbol] UNIVERSITY OF MN SYSTEM: [Symbol] FAIRGROUNDS: [Symbol]		HYDROLOGIC FEATURES RIVER OR STREAM (PERENNIAL): [Symbol] LAKE, POND OR RESERVOIR: [Symbol] STREAM (INTERMITTENT): [Symbol] DRAINAGE DITCH: [Symbol] WETLAND: [Symbol] ISLAND OR LAND MONUMENT: [Symbol] REGIONAL WATERSHED: [Symbol]	

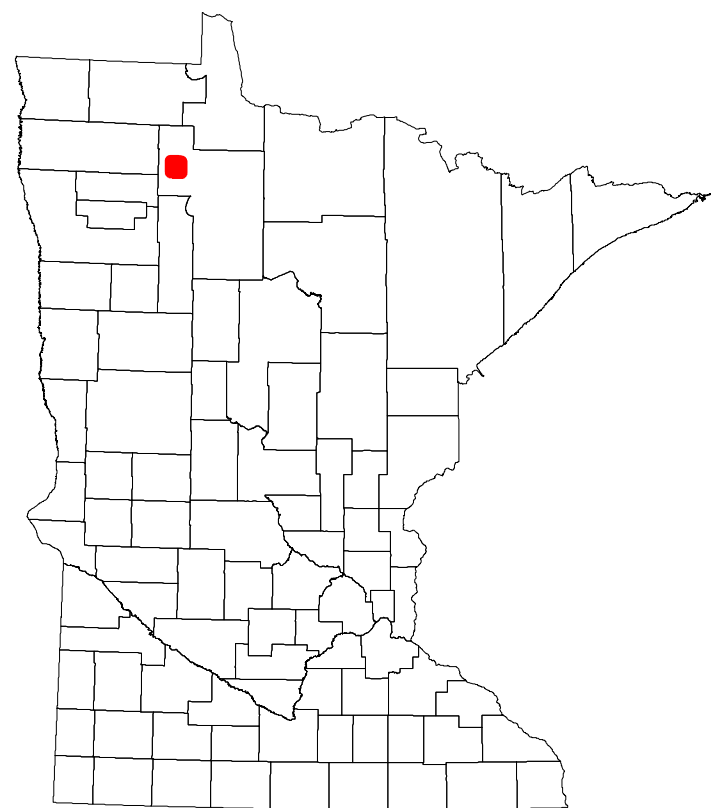

Population (U.S. Census 2010): 13

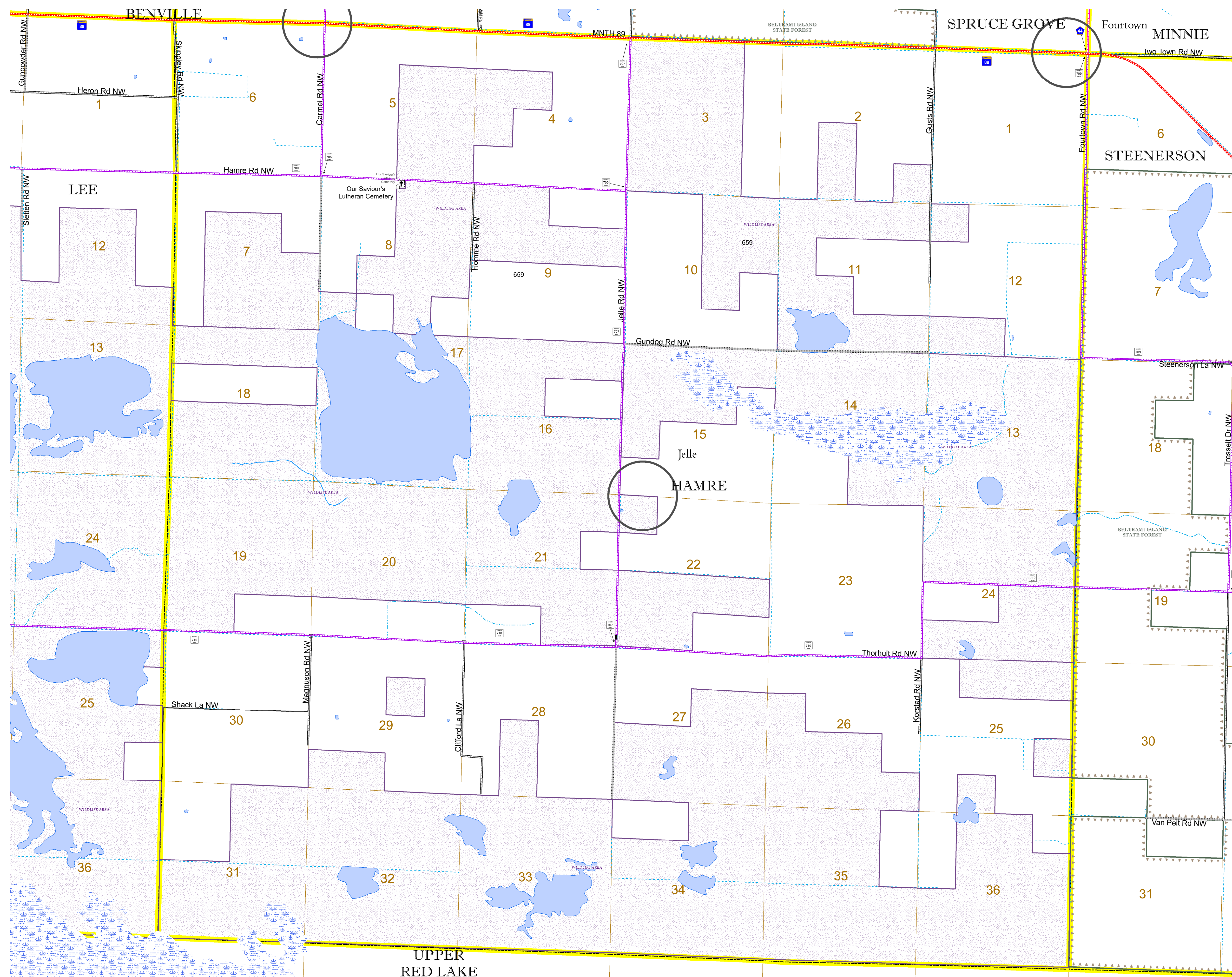

To request information from this document in an alternative format, call 651-366-4718 or 1-800-657-3774 (Greater Minnesota); 711 or 1-800-627-3529 (Minnesota Relay). You may also send an e-mail to ADAREquest.dot@state.mn.us. (Please request at least one week in advance.)