

TOWNSHIP OF MOONSHINE

PREPARED BY THE
MINNESOTA DEPARTMENT OF TRANSPORTATION
OFFICE OF TRANSPORTATION SYSTEM MANAGEMENT

IN COOPERATION WITH
U.S. DEPARTMENT OF TRANSPORTATION
FEDERAL HIGHWAY ADMINISTRATION

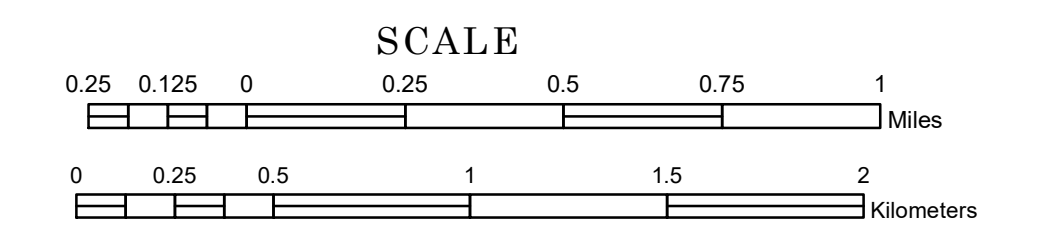

2022

Projection:
Transverse Mercator
NAD 1986
UTM Zone 15

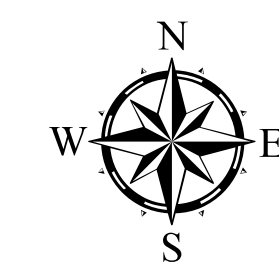

North American Datum
of 1986

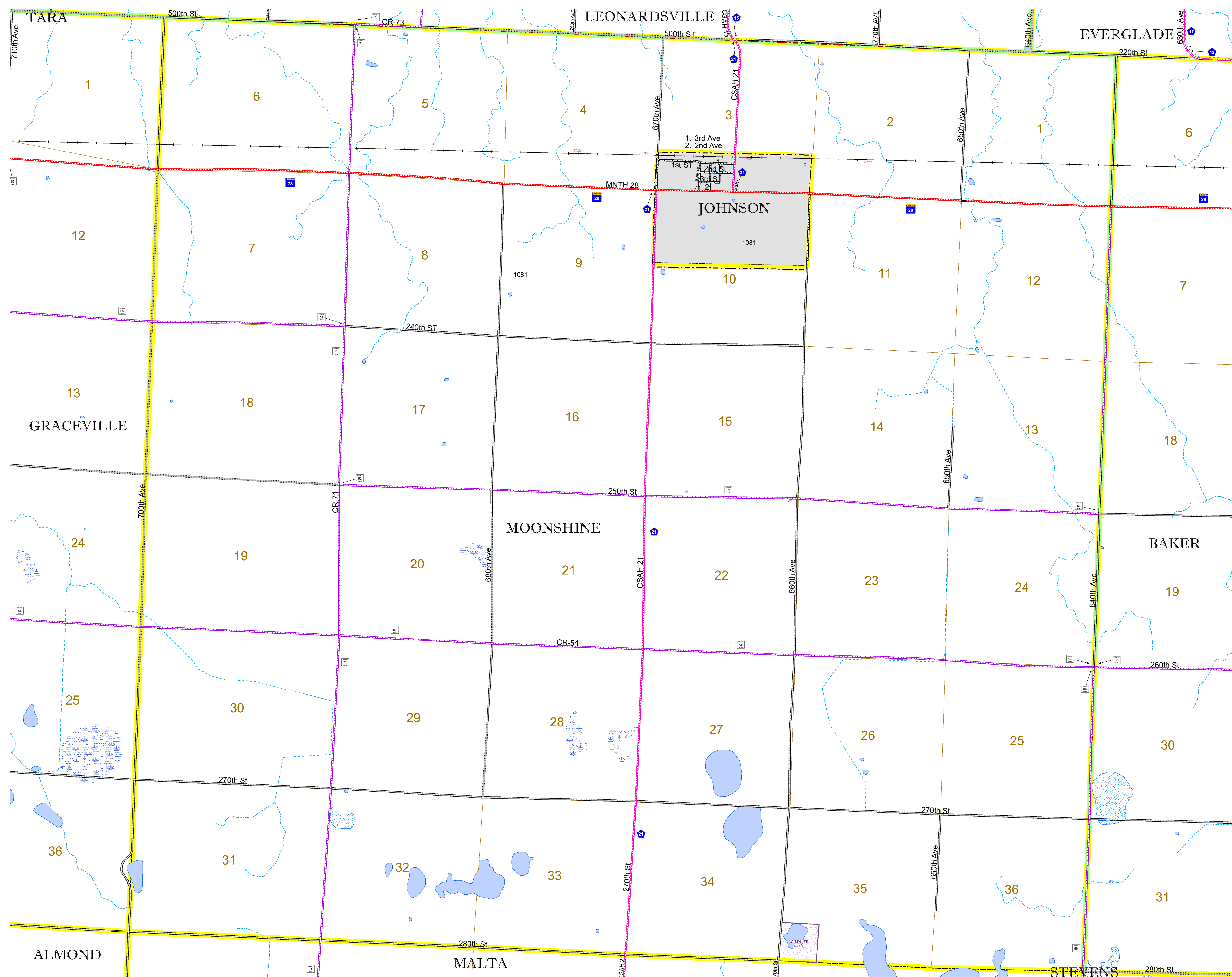

ROAD AND ROADWAY FEATURES		RAILROAD AND RAILWAY FEATURES		AVIATION FEATURES	
INTERSTATE	CONCRETE	EMPIRE BUILDER STATION (AMTRAK)	COMMERCIAL AIRPORT	GENERAL AIRPORT	TRIBAL LAND
US HIGHWAY	BITUMINOUS	NORTHSTAR STATION (COMMUTER)	AIRSTRIP	AIRSTRIP	STATE OF MINNESOTA
MN HIGHWAY	GRAVEL	LIGHT RAIL	SEAPLANE	SEAPLANE	COUNTY
COUNTY STATE AID HIGHWAY	DIRT/UNIMPROVED	BLUE LINE	AIRPORT RUNWAY	AIRPORT RUNWAY	MUNICIPALITY
COUNTY ROAD	OTHER	GREEN LINE	BOUNDARY FEATURES	BOUNDARY FEATURES	UNORGANIZED TERRITORY
TOWNSHIP ROAD	UNKNOWN	INFRASTRUCTURE FEATURES	UNINCORPORATED COMMUNITY	UNINCORPORATED COMMUNITY	CIVIL TOWNSHIP
UNORGANIZED TERRITORY ROAD		LONG BRIDGE (200' OR GREATER SPAN)	SECTION	SECTION	CONGRESSIONAL TOWNSHIP
OTHER ROADS		MAJOR BRIDGE (20' TO 200' SPAN)	MILITARY	MILITARY	
MUNICIPAL		MINOR BRIDGE (5' TO 20' SPAN)	VOYAGEURS NATIONAL PARK	VOYAGEURS NATIONAL PARK	
PRIVATE		DAM	BOUNDARY WATERS CANOE AREA WILDERNESS	BOUNDARY WATERS CANOE AREA WILDERNESS	
NATIVE SERVICE		LOCK AND DAM	STATE PARK	STATE PARK	
NATIONAL PARK			REGIONAL PARK	REGIONAL PARK	
NATIONAL WILDLIFE REFUGES			NATIONAL FOREST	NATIONAL FOREST	
STATE PARK			NATIONAL AND STATE FOREST	NATIONAL AND STATE FOREST	
PRESERVE			STATE FOREST	STATE FOREST	
			NATIONAL TRAIL	NATIONAL TRAIL	
			WILDLIFE REFUGE AREA	WILDLIFE REFUGE AREA	
			WILDLIFE MANAGEMENT AREA	WILDLIFE MANAGEMENT AREA	
			HYDROLOGIC FEATURES	HYDROLOGIC FEATURES	
			RIVER OR STREAM (PERMANENT)	RIVER OR STREAM (PERMANENT)	
			LAKE, POND OR RESERVOIR	LAKE, POND OR RESERVOIR	
			STREAM (INTERMITTENT)	STREAM (INTERMITTENT)	
			DRAINAGE DITCH	DRAINAGE DITCH	
			WETLAND	WETLAND	
			ISLAND OR LAND MONUMENT	ISLAND OR LAND MONUMENT	
			REGIONAL WATERSHED	REGIONAL WATERSHED	

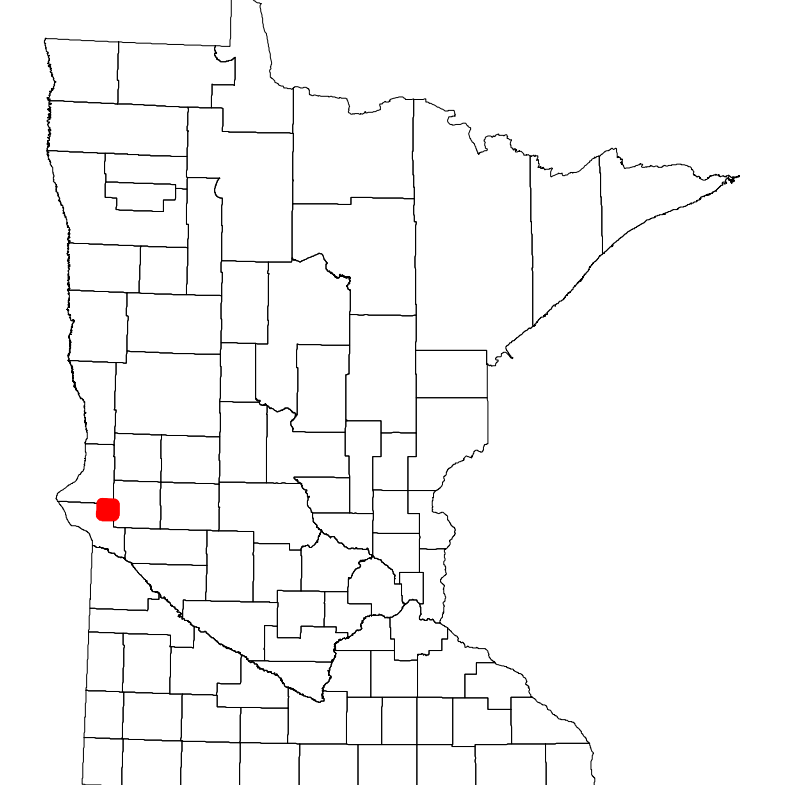

Population (U.S. Census 2010): 131

To request information from this document in an alternative format, call 651-366-4718 or 1-800-657-3774 (Greater Minnesota); 711 or 1-800-627-3529 (Minnesota Relay). You may also send an e-mail to ADRequest.dot@state.mn.us. (Please request at least one week in advance.)