

# TOWNSHIP OF JENKINS

PREPARED BY THE  
MINNESOTA DEPARTMENT OF TRANSPORTATION  
OFFICE OF TRANSPORTATION SYSTEM MANAGEMENT

IN COOPERATION WITH  
U.S. DEPARTMENT OF TRANSPORTATION  
FEDERAL HIGHWAY ADMINISTRATION

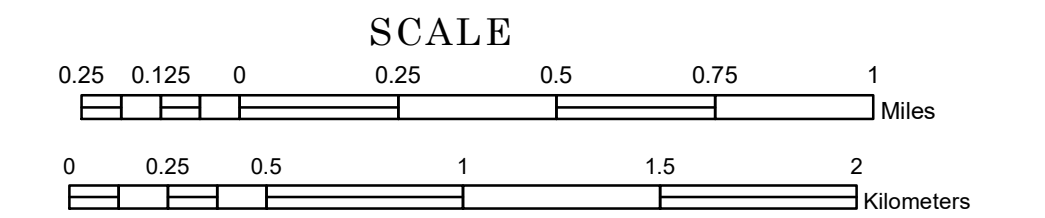

1 in = 1,600 ft  
**2022**

Projection:  
Transverse Mercator  
NAD 1986  
UTM Zone 15



North American Datum  
of 1986

ROAD AND ROADWAY FEATURES		BOUNDARY FEATURES	
INTERSTATE		CONCRETE	
US HIGHWAY		BITUMINOUS	
MN HIGHWAY		GRAVEL	
COUNTY STATE AID HIGHWAY		DIRT/UNIMPROVED	
COUNTY ROAD		OTHER	
TOWNSHIP ROAD		UNKNOWN	
UNORGANIZED TERRITORY ROAD		RAMP OR CONNECTOR	
OTHER ROADS		INTERSTATE EXIT	
Municipal		GREAT RIVER ROAD	
Private		AVIATION FEATURES	
National Monument		COMMERCIAL AIRPORT	
State Forest		GENERAL AIRPORT	
Nature Service		AIRSTRIP	
Military		SEAPLANE	
National Park		AIRPORT RUNWAY	
National Wildlife Refuge		TRIAL LAND	
State Game Preserve		STATE OF MINNESOTA	
RAILROAD AND RAILWAY FEATURES		COUNTY	
EMPIRE BUILDER STATION (AMTRAK)		MUNICIPALITY	
NORTHSTAR STATION (COMPUTER)		UNORGANIZED TERRITORY	
LIGHT RAIL		FEDERAL ADJUSTED URBAN AREA (2014)	
BLUE LINE		CIVIL TOWNSHIP	
GREEN LINE		CONGRESSIONAL TOWNSHIP	
INFRASTRUCTURE FEATURES		SECTION	
LONG BRIDGE (200' OR GREATER SPAN)		MILITARY	
MAJOR BRIDGE (20' TO 200' SPAN)		VOYAGEURS NATIONAL PARK	
MINOR BRIDGE (5' TO 20' SPAN)		BOUNDARY WATERS CANOE AREA WILDERNESS	
LOCK AND DAM		STATE PARK	
CITY CENTERS		REGIONAL PARK	
STATE CAPITAL		NATIONAL FOREST	
COUNTY SEAT		NATIONAL AND STATE FOREST	
CITY CENTER		STATE FOREST	
UNINCORPORATED COMMUNITY		NATIONAL TRAIL	
PUBLIC SERVICE FEATURES		WILDLIFE REFUGE AREA	
MNDOT OFFICE		WILDLIFE MANAGEMENT AREA	
MNDOT TRUCK STATION		HYDROLOGIC FEATURES	
HIGHWAY PATROL DISTRICT OFFICE		RIVER OR STREAM (PERMANENT)	
STATE TRAVEL INFORMATION CENTER		LAKE, POND OR RESERVOIR	
REST AREA (FULL SERVICE)		STREAM (INTERMITTENT)	
REST AREA (VAULT TOILET)		DRAINAGE DITCH	
WAYSIDE (VAULT OR PIT TOILET)		WETLAND	
PARK AND RIDE LOT		ISLAND OR LAND	
PORT OF ENTRY		REGIONAL WATERSHED	
PUBLIC ACCESS POINT			
MN STATE COLLEGE AND UNIVERSITY SYSTEM (MNSCU)			
UNIVERSITY OF MN SYSTEM			
FAIRGROUNDS			
CULTURAL FEATURES			
STATE HISTORICAL MARKER			
HISTORIC DISTRICT			
HISTORIC SITE			
MONUMENT			

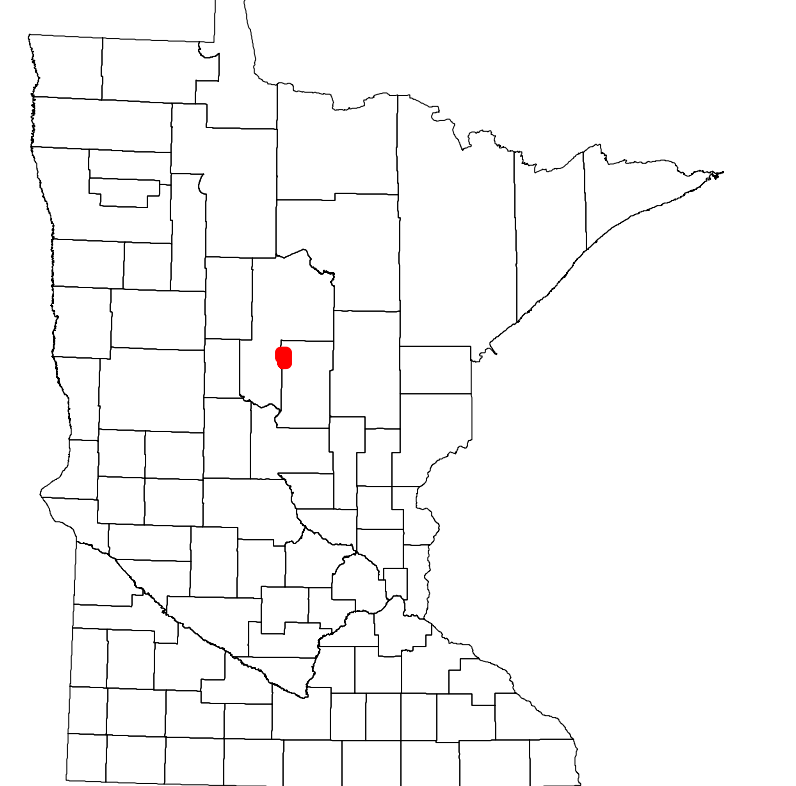

Population (U.S. Census 2010): 359

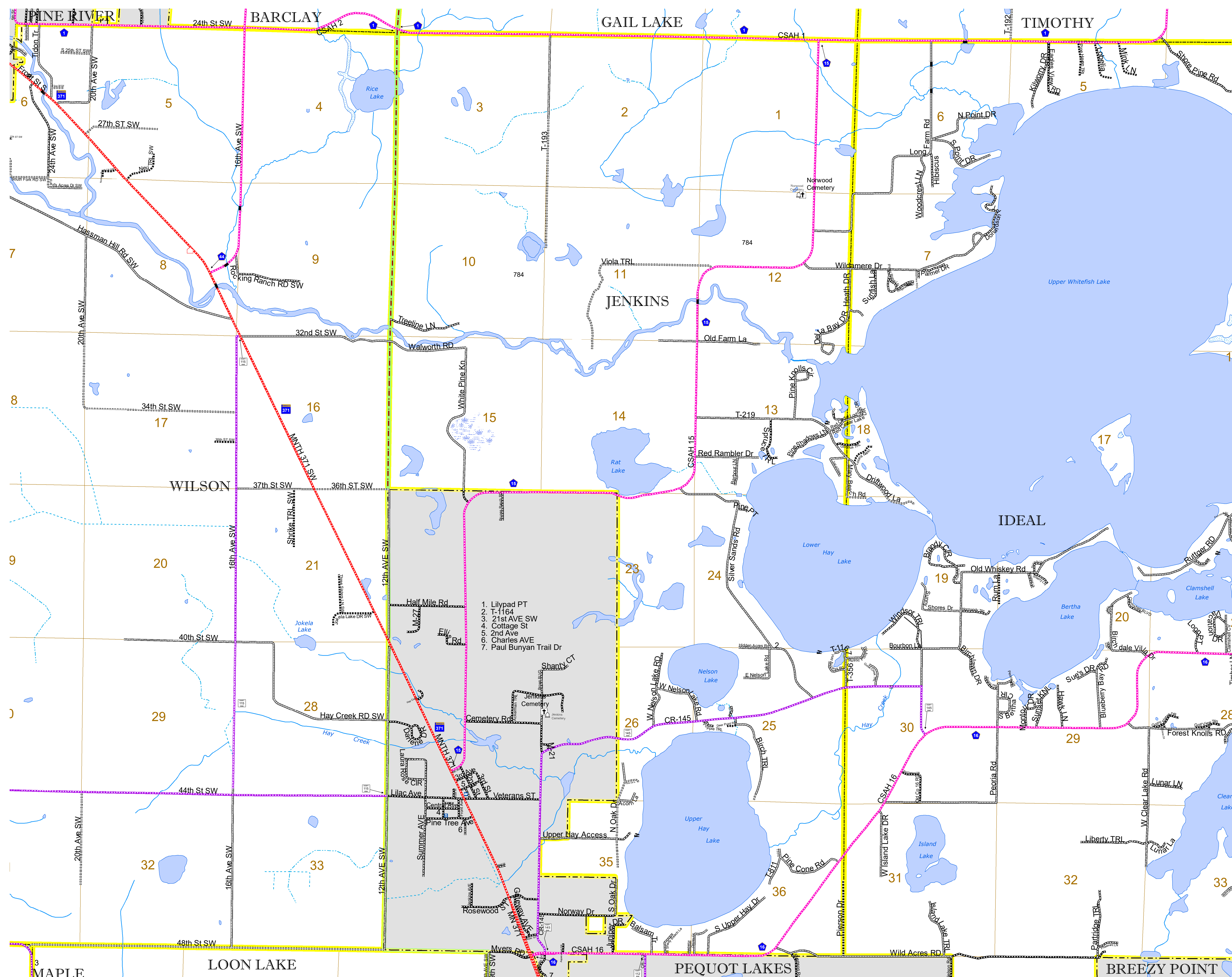

1. Lilypad PT
2. T-1164
3. Cottage St
4. 2nd Ave
5. Charles AVE
6. Paul Bunyan Trail Dr
7. Paul Bunyan Trail Dr

To request information from this document in an alternative format, call 651-366-4718 or 1-800-657-3774 (Greater Minnesota); 711 or 1-800-627-3529 (Minnesota Relay). You may also send an e-mail to ADARquest.dot@state.mn.us. (Please request at least one week in advance.)