

# TOWNSHIP OF NOKAY LAKE

PREPARED BY THE  
MINNESOTA DEPARTMENT OF TRANSPORTATION  
OFFICE OF TRANSPORTATION SYSTEM MANAGEMENT

IN COOPERATION WITH  
U.S. DEPARTMENT OF TRANSPORTATION  
FEDERAL HIGHWAY ADMINISTRATION

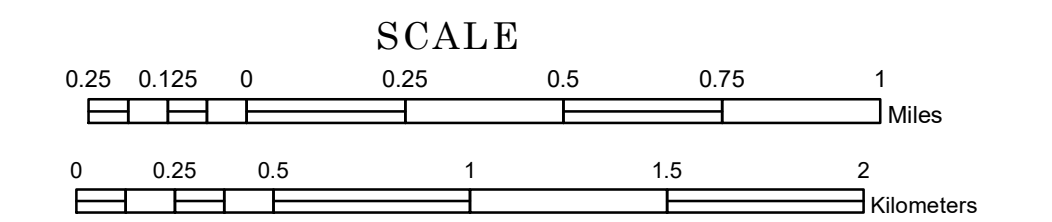

1 in = 1,600 ft  
**2022**

Projection:  
Transverse Mercator  
NAD 1986  
UTM Zone 15



North American Datum  
of 1986

ROAD AND ROADWAY FEATURES			
INTERSTATE	CONCRETE		
US HIGHWAY	BITUMINOUS		
MN HIGHWAY	GRAVEL		
COUNTY STATE AID HIGHWAY	DIRT/UNIMPROVED		
COUNTY ROAD	OTHER		
TOWNSHIP ROAD	UNKNOWN		
UNORGANIZED TERRITORY ROAD			
OTHER ROADS	RAMP OR CONNECTOR		
Municipal	Private	National Monument	State Forest
Nature Service	National Park	National Wildlife	State Game
Military	National Forest	State Park	Preserve
RAILROAD AND RAILWAY FEATURES			
EMPIRE BUILDER STATION (AMTRAK)	COMMERCIAL AIRPORT		
NORTHSTAR STATION (COMMUTER)	GENERAL AIRPORT		
LIGHT RAIL	AIRSTRIP		
BLUE LINE	SEAPLANE		
GREEN LINE	AIRPORT RUNWAY		
INFRASTRUCTURE FEATURES			
LONG BRIDGE (200' or Greater Span)	TRIAL LAND		
MAJOR BRIDGE (20' to 200' Span)	STATE OF MINNESOTA		
MINOR BRIDGE (5' to 20' Span)	COUNTY		
LOCK AND DAM	MUNICIPALITY		
CITY CENTERS			
STATE CAPITAL	CITY CENTER		
COUNTY SEAT	UNINCORPORATED COMMUNITY		
PUBLIC SERVICE FEATURES			
MNDOT OFFICE	MILITARY		
MNDOT TRUCK STATION	VOYAGEURS NATIONAL PARK		
HIGHWAY PATROL DISTRICT OFFICE	BOUNDARY WATERS CANOE AREA WILDERNESS		
STATE TRAVEL INFORMATION CENTER	STATE PARK		
REST AREA (Full Service)	REGIONAL PARK		
REST AREA (Vault Toilet)	NATIONAL FOREST		
WAYSIDE (Vault or Pit Toilet)	NATIONAL AND STATE FOREST		
PARK AND RIDE LOT	STATE FOREST		
PORT OF ENTRY	NATIONAL TRAIL		
PUBLIC ACCESS POINT	WILDLIFE REFUGUE AREA		
MN STATE COLLEGE AND UNIVERSITY SYSTEM (MNSCU)	WILDLIFE MANAGEMENT AREA		
UNIVERSITY OF MN SYSTEM	HYDROLOGIC FEATURES		
FAIRGROUNDS	RIVER OR STREAM (PERMANENT)		
CULTURAL FEATURES			
STATE HISTORICAL MARKER	LAKE, POND OR RESERVOIR		
HISTORIC DISTRICT	STREAM (INTERMITTENT)		
HISTORIC SITE	DRAINAGE DITCH		
MONUMENT	WETLAND		
	ISLAND OR LAND		
	REGIONAL WATERSHED		

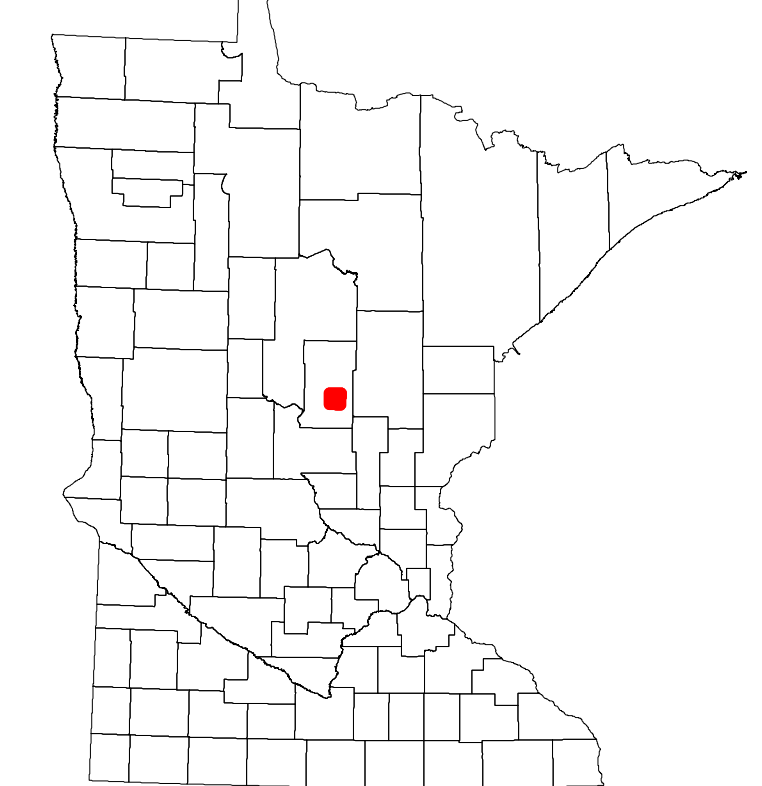

Population (U.S. Census 2010): 830

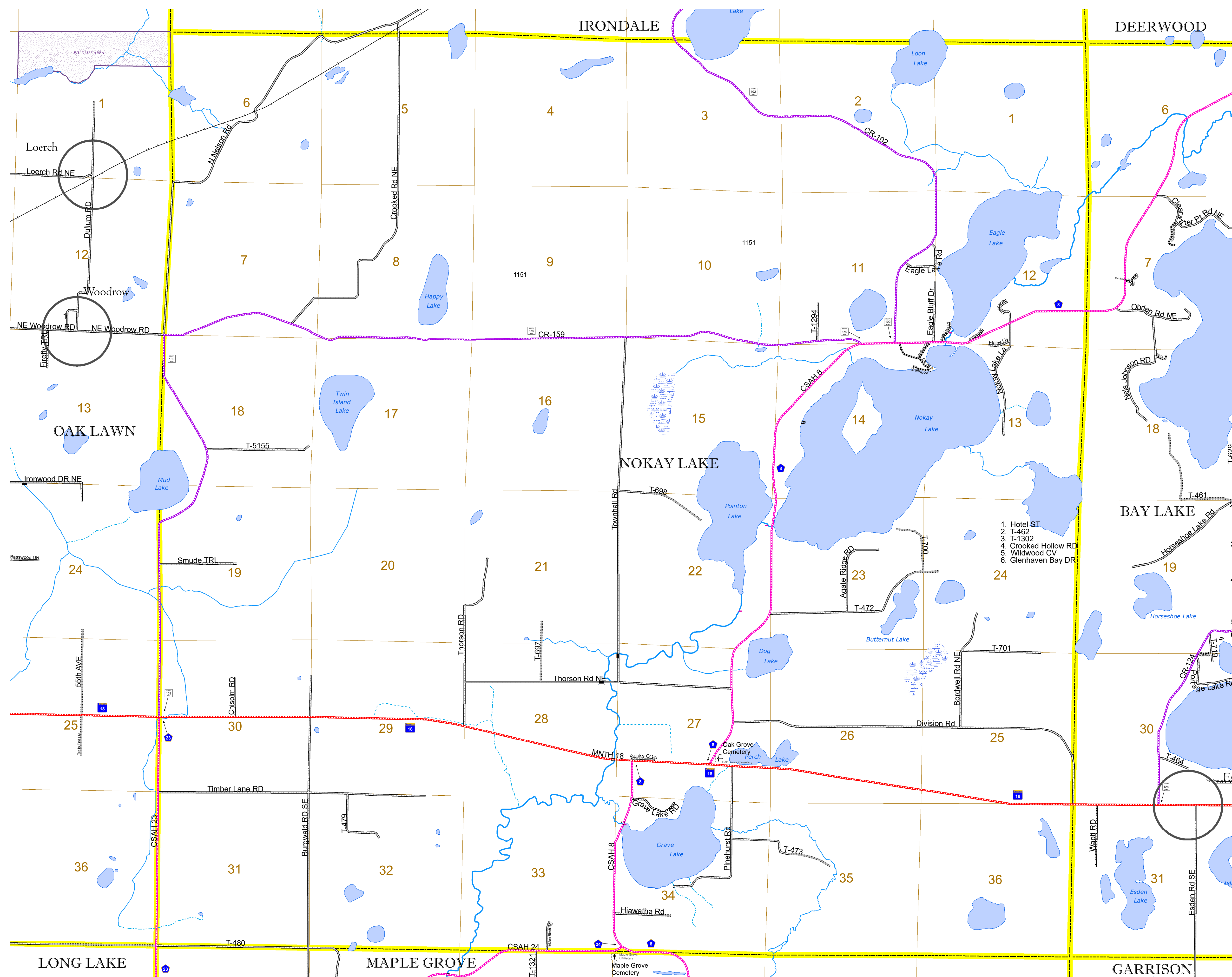

To request information from this document in an alternative format, call 651-366-4718 or 1-800-657-3774 (Greater Minnesota); 711 or 1-800-627-3529 (Minnesota Relay). You may also send an e-mail to [ADArequest.dot@state.mn.us](mailto:ADArequest.dot@state.mn.us). (Please request at least one week in advance.)