

TOWNSHIP OF SCIOTA

PREPARED BY THE
MINNESOTA DEPARTMENT OF TRANSPORTATION
OFFICE OF TRANSPORTATION SYSTEM MANAGEMENT

IN COOPERATION WITH
U.S. DEPARTMENT OF TRANSPORTATION
FEDERAL HIGHWAY ADMINISTRATION

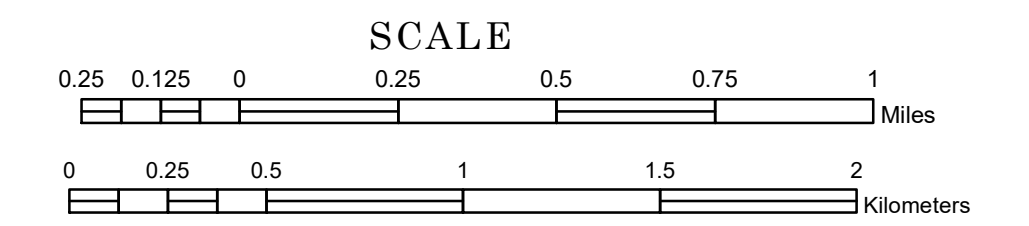

2023

Projection:
Transverse Mercator
NAD 1986
UTM Zone 15

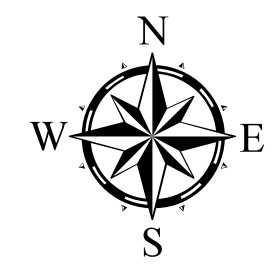

North American Datum
of 1986

ROAD AND ROADWAY FEATURES		BOUNDARY FEATURES	
INTERSTATE		CONCRETE	
US HIGHWAY		BITUMINOUS	
MN HIGHWAY		GRAVEL	
COUNTY STATE AID HIGHWAY		DIRT/UNIMPROVED	
COUNTY ROAD		OTHER	
TOWNSHIP ROAD		UNKNOWN	
UNORGANIZED TERRITORY ROAD		RAMP OR CONNECTOR	
OTHER ROADS		INTERSTATE EXIT	
Municipal		AVIATION FEATURES	
Private		COMMERCIAL AIRPORT	
National Monument		GENERAL AIRPORT	
State Forest		AIRSTRIP	
Nature Service		SEAPLANE	
National Park		AIRPORT RUNWAY	
National Wildlife		STATE OF MINNESOTA	
State Park		COUNTY	
Preserve		MUNICIPALITY	
RAILROAD AND RAILWAY FEATURES		UNORGANIZED TERRITORY	
EMPIRE BUILDER STATION (AMTRAK)		FEDERAL ADJUSTED URBAN AREA (2014)	
NORTHSTAR STATION (COMPUTER)		CIVIL TOWNSHIP	
LONG BRIDGE (200' OR GREATER SPAN)		CONGRESSIONAL TOWNSHIP	
MAJOR BRIDGE (20' TO 200' SPAN)		SECTION	
MINOR BRIDGE (5' TO 20' SPAN)		MILITARY	
LOCK AND DAM		VOYAGEURS NATIONAL PARK	
CITY CENTERS		BOUNDARY WATERS CANOE AREA WILDERNESS	
STATE CAPITAL		STATE PARK	
COUNTY SEAT		REGIONAL PARK	
CITY CENTER		NATIONAL FOREST	
UNINCORPORATED COMMUNITY		NATIONAL AND STATE FOREST	
PUBLIC SERVICE FEATURES		STATE FOREST	
MNDOT OFFICE		NATIONAL TRAIL	
MNDOT TRUCK STATION		WILDLIFE REFUGUE AREA	
HIGHWAY PATROL DISTRICT OFFICE		WILDLIFE MANAGEMENT AREA	
STATE TRAVEL INFORMATION CENTER		HYDROLOGIC FEATURES	
REST AREA (Full Service)		RIVER OR STREAM (PERMANENT)	
REST AREA (Vault Toilets)		LAKE, POND OR RESERVOIR	
WAYSIDE (Vault or Pit Toilets)		STREAM (INTERMITTENT)	
PARK AND RIDE LOT		DRAINAGE DITCH	
PORT OF ENTRY		WETLAND	
PUBLIC ACCESS POINT		ISLAND OR LAND	
MN STATE COLLEGE AND UNIVERSITY SYSTEM (MNSCU)		REGIONAL WATERSHED	
UNIVERSITY OF MN SYSTEM			
FAIRGROUNDS			
CULTURAL FEATURES			
STATE HISTORICAL MARKER			
HISTORIC DISTRICT			
HISTORIC SITE			
MONUMENT			



Population (U.S. Census 2010): 414

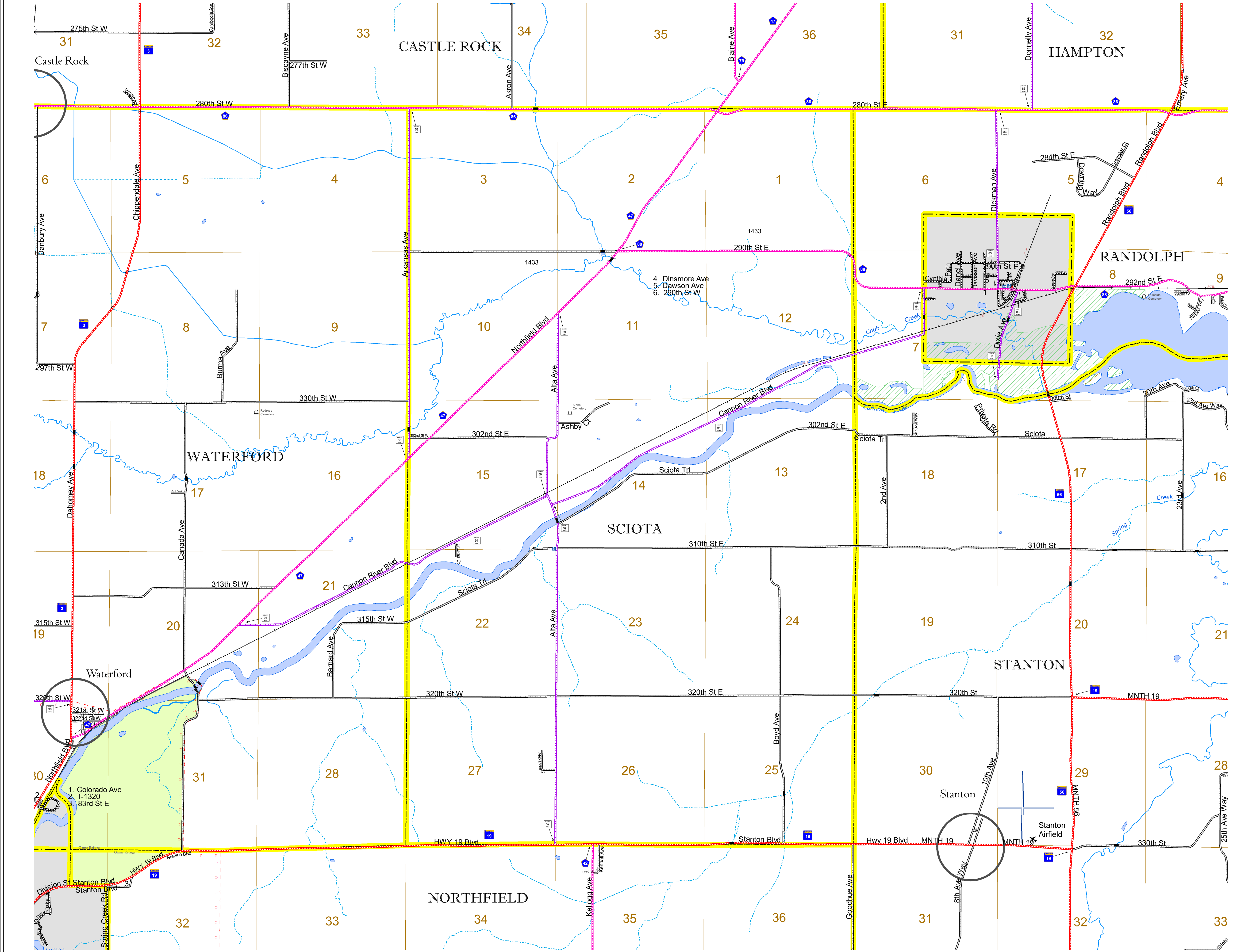

To request information from this document in an alternative format, call 651-366-4718 or 1-800-657-3774 (Greater Minnesota); 711 or 1-800-627-3529 (Minnesota Relay). You may also send an e-mail to ADRequest.dot@state.mn.us. (Please request at least one week in advance.)