

# TOWNSHIP OF DUNBAR

PREPARED BY THE  
MINNESOTA DEPARTMENT OF TRANSPORTATION  
OFFICE OF TRANSPORTATION SYSTEM MANAGEMENT

IN COOPERATION WITH  
U.S. DEPARTMENT OF TRANSPORTATION  
FEDERAL HIGHWAY ADMINISTRATION



1 in = 1,600 ft  
**2022**

Projection:  
Transverse Mercator  
NAD 1986  
UTM Zone 15



North American Datum  
of 1986

ROAD AND ROADWAY FEATURES		AVIATION FEATURES	
INTERSTATE	CONCRETE	COMMERCIAL AIRPORT	GENERAL AIRPORT
US HIGHWAY	BITUMINOUS	AIRSTRIP	SEAPLANE
MN HIGHWAY	GRAVEL	AIRPORT RUNWAY	AIRPORT RUNWAY
COUNTY STATE AID HIGHWAY	DIRT/UNIMPROVED		
COUNTY ROAD	OTHER		
TOWNSHIP ROAD	UNKNOWN		
UNORGANIZED TERRITORY ROAD			
OTHER ROADS			
Municipal Private National Monument State Forest			
Nature Service National Park National Wildlife State Game			
Museum National Forest State Park Preserve			
RAILROAD AND RAILWAY FEATURES		BOUNDARY FEATURES	
EMPIRE BUILDER STATION (AMTRAK)	TRIBAL LAND	STATE OF MINNESOTA	COUNTY
NORTHSTAR STATION (COMPUTER)	STATE OF MINNESOTA	MUNICIPALITY	UNORGANIZED TERRITORY
LIGHT RAIL	STATE OF MINNESOTA	FEDERAL ADJUSTED URBAN AREA (2014)	CIVIL TOWNSHIP
BLUE LINE	STATE OF MINNESOTA	CONGRESSIONAL TOWNSHIP	SECTION
GREEN LINE	STATE OF MINNESOTA	MILITARY	VOYAGEURS NATIONAL PARK
LONG BRIDGE (200' or Greater Span)	STATE OF MINNESOTA	BOUNDARY WATERS CANOE AREA WILDERNESS	STATE PARK
MAJOR BRIDGE (20' to 200' Span)	STATE OF MINNESOTA	REGIONAL PARK	NATIONAL FOREST
MINOR BRIDGE (5' to 20' Span)	STATE OF MINNESOTA	NATIONAL AND STATE FOREST	STATE FOREST
DAM	STATE OF MINNESOTA	NATIONAL TRAIL	WILDLIFE REFUGUE AREA
LOCK AND DAM	STATE OF MINNESOTA	FEDERAL ADJUSTED URBAN AREA (2014)	WILDLIFE MANAGEMENT AREA
	STATE OF MINNESOTA	CIVIL TOWNSHIP	HYDROLOGIC FEATURES
	STATE OF MINNESOTA	CONGRESSIONAL TOWNSHIP	RIVER OR STREAM (PERMANENT)
	STATE OF MINNESOTA	MILITARY	LAKE, POND OR RESERVOIR
	STATE OF MINNESOTA	VOYAGEURS NATIONAL PARK	STREAM (INTERMITTENT)
	STATE OF MINNESOTA	BOUNDARY WATERS CANOE AREA WILDERNESS	DRAINAGE DITCH
	STATE OF MINNESOTA	STATE PARK	WETLAND
	STATE OF MINNESOTA	REGIONAL PARK	ISLAND OR LAND
	STATE OF MINNESOTA	NATIONAL FOREST	REGIONAL WATERSHED
	STATE OF MINNESOTA	NATIONAL AND STATE FOREST	
	STATE OF MINNESOTA	STATE FOREST	
	STATE OF MINNESOTA	NATIONAL TRAIL	
	STATE OF MINNESOTA	WILDLIFE REFUGUE AREA	
	STATE OF MINNESOTA	WILDLIFE MANAGEMENT AREA	
	STATE OF MINNESOTA	HYDROLOGIC FEATURES	
	STATE OF MINNESOTA	RIVER OR STREAM (PERMANENT)	
	STATE OF MINNESOTA	LAKE, POND OR RESERVOIR	
	STATE OF MINNESOTA	STREAM (INTERMITTENT)	
	STATE OF MINNESOTA	DRAINAGE DITCH	
	STATE OF MINNESOTA	WETLAND	
	STATE OF MINNESOTA	ISLAND OR LAND	
	STATE OF MINNESOTA	REGIONAL WATERSHED	

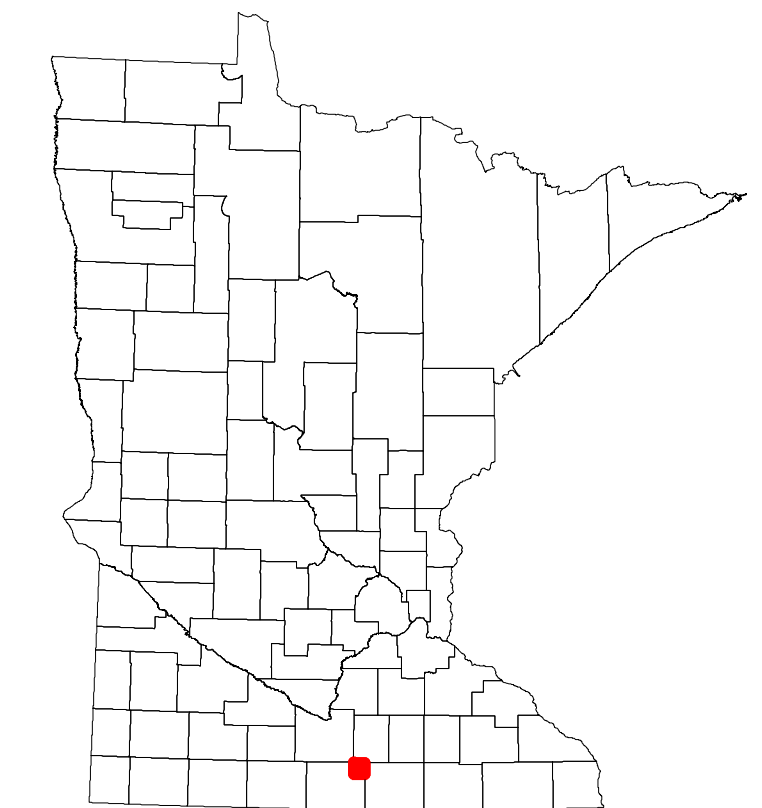

Population (U.S. Census 2010): 283

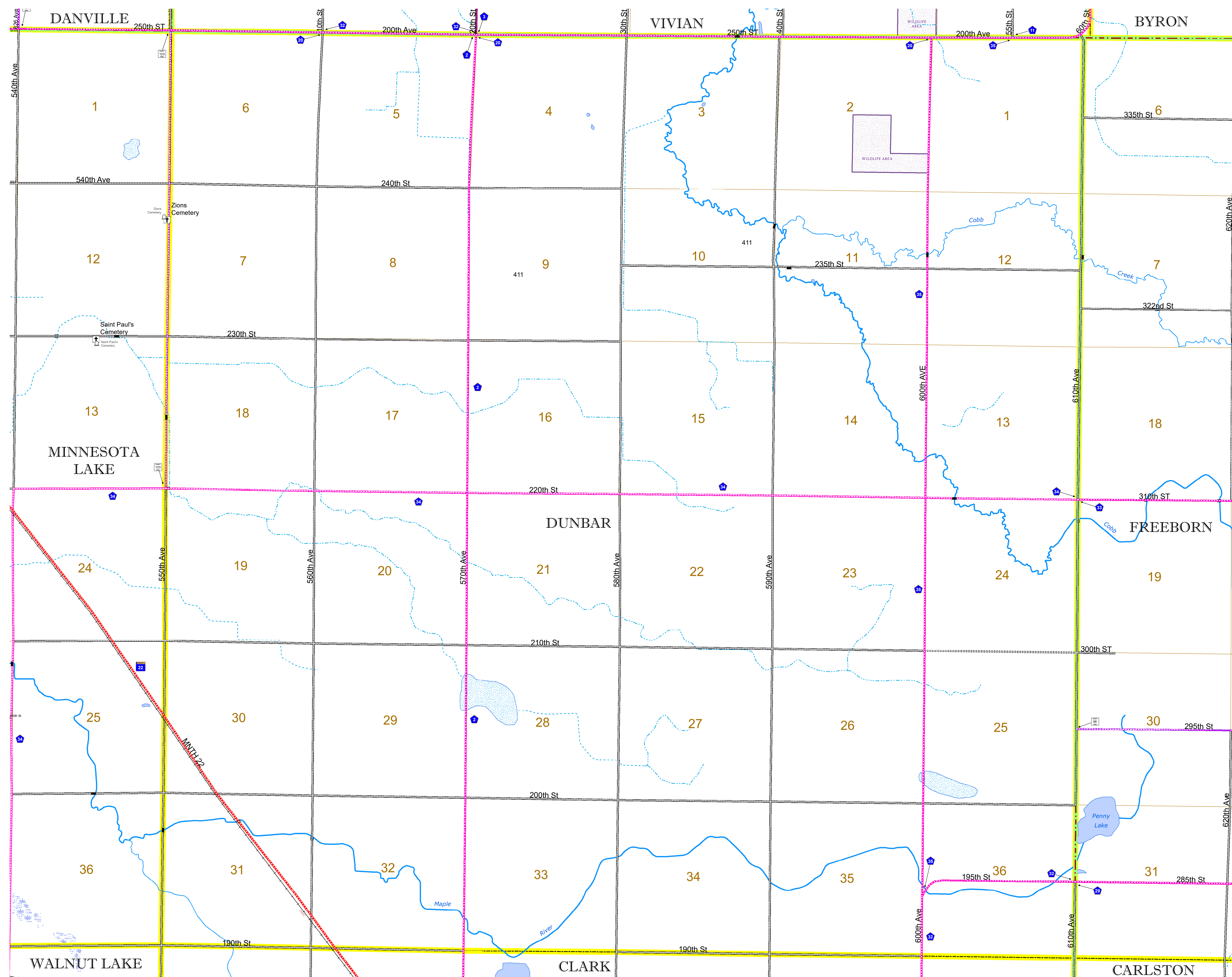

To request information from this document in an alternative format, call 651-366-4718 or 1-800-657-3774 (Greater Minnesota); 711 or 1-800-627-3529 (Minnesota Relay). You may also send an e-mail to ADarequest.dot@state.mn.us. (Please request at least one week in advance.)