

TOWNSHIP OF SINNOTT

PREPARED BY THE
MINNESOTA DEPARTMENT OF TRANSPORTATION
OFFICE OF TRANSPORTATION SYSTEM MANAGEMENT

IN COOPERATION WITH
U.S. DEPARTMENT OF TRANSPORTATION
FEDERAL HIGHWAY ADMINISTRATION

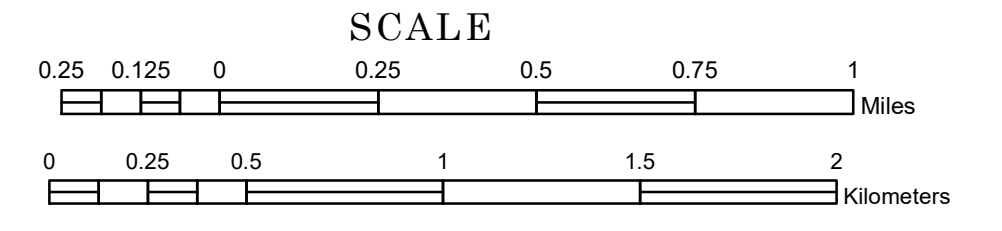

2022

Projection:
Transverse Mercator
NAD 1986
UTM Zone 15

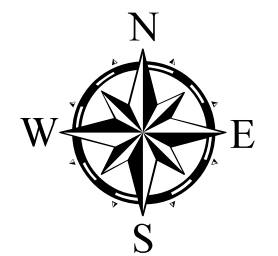

North American Datum
of 1986

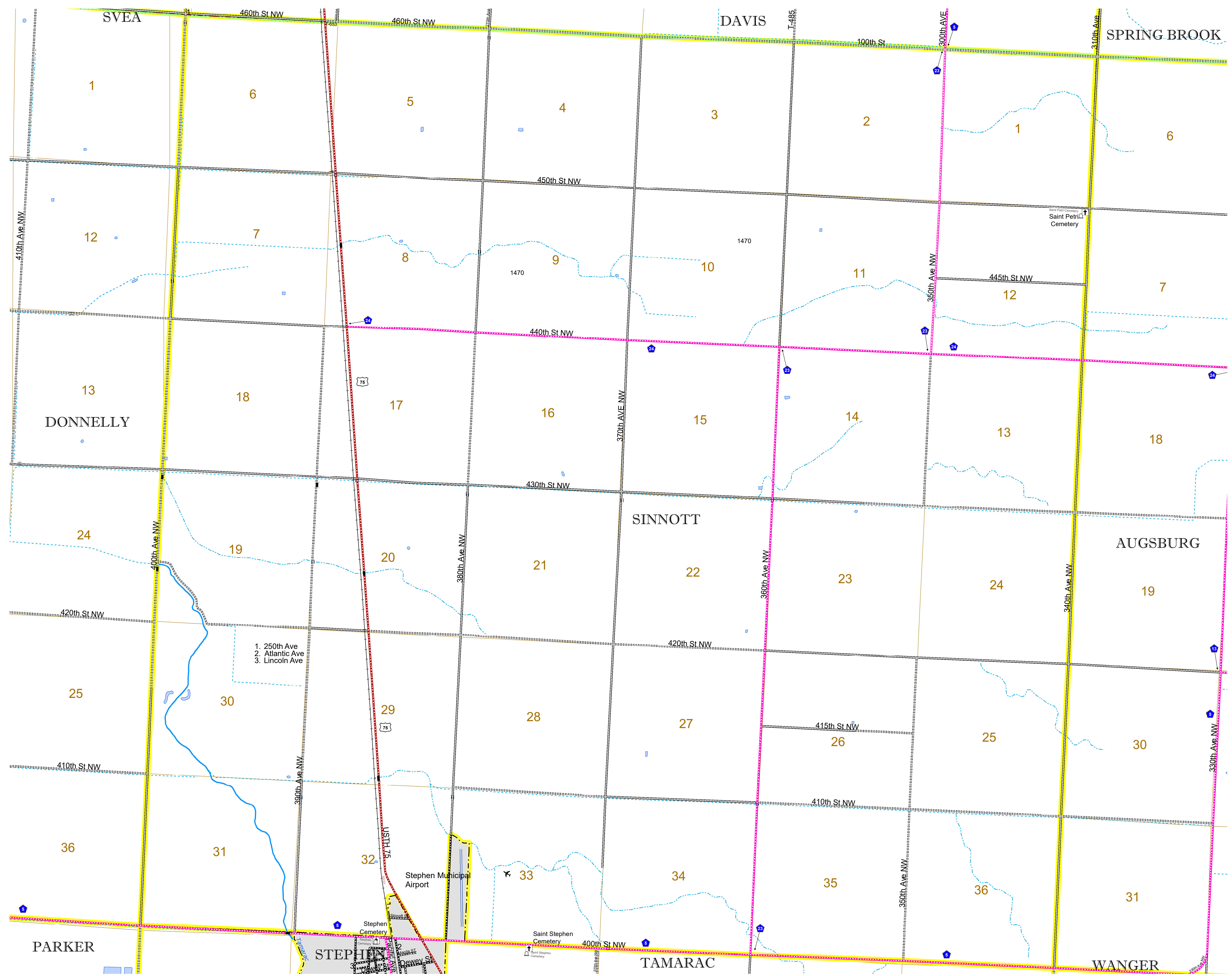

ROAD AND ROADWAY FEATURES		RAILROAD AND RAILWAY FEATURES		AVIATION FEATURES	
INTERSTATE	CONCRETE	EMPIRE BUILDER STATION (AMTRAK)	COMMERCIAL AIRPORT	TRIBAL LAND	BOUNDARY FEATURES
US HIGHWAY	BITUMINOUS	NORTHSTAR STATION (COMMUTER)	GENERAL AIRPORT	STATE OF MINNESOTA	COUNTY
MN HIGHWAY	GRAVEL	LIGHT RAIL	AIRSTRIP	MUNICIPALITY	MUNICIPALITY
COUNTY STATE AID HIGHWAY	DIRT/UNIMPROVED	BLUE LINE	SEAPLANE	UNORGANIZED TERRITORY	UNORGANIZED TERRITORY
COUNTY ROAD	OTHER	GREEN LINE	AIRPORT RUNWAY	FEDERAL ADJUSTED URBAN AREA (2014)	CIVIL TOWNSHIP
TOWNSHIP ROAD	UNKNOWN	INFRASTRUCTURE FEATURES	LONG BRIDGE (200' OR GREATER SPAN)	LOCK-AND-DAM	CITY CENTERS
UNORGANIZED TERRITORY ROAD	RAMP OR CONNECTOR	LONG BRIDGE (20' TO 200' SPAN)	MAJOR BRIDGE (20' TO 200' SPAN)	STATE CAPITAL	CITY CENTER
OTHER ROADS	INTERSTATE EXIT	MINOR BRIDGE (5' TO 20' SPAN)	DAM	COUNTY SEAT	CITY CENTER
Municipal	INTERSTATE EXIT	LOCK-AND-DAM	STATE CAPITAL	CITY CENTER	CITY CENTER
Private	INTERSTATE EXIT	STATE CAPITAL	CITY CENTER	CITY CENTER	CITY CENTER
National Monument	INTERSTATE EXIT	CITY CENTER	CITY CENTER	CITY CENTER	CITY CENTER
State Forest	INTERSTATE EXIT	CITY CENTER	CITY CENTER	CITY CENTER	CITY CENTER
National Wildlife Refuge	INTERSTATE EXIT	CITY CENTER	CITY CENTER	CITY CENTER	CITY CENTER
State Park	INTERSTATE EXIT	CITY CENTER	CITY CENTER	CITY CENTER	CITY CENTER
Preserve	INTERSTATE EXIT	CITY CENTER	CITY CENTER	CITY CENTER	CITY CENTER
RAILROAD AND RAILWAY FEATURES	RAILROAD AND RAILWAY FEATURES	RAILROAD AND RAILWAY FEATURES	RAILROAD AND RAILWAY FEATURES	RAILROAD AND RAILWAY FEATURES	RAILROAD AND RAILWAY FEATURES
COMMERCIAL AIRPORT	COMMERCIAL AIRPORT	COMMERCIAL AIRPORT	COMMERCIAL AIRPORT	COMMERCIAL AIRPORT	COMMERCIAL AIRPORT
GENERAL AIRPORT	GENERAL AIRPORT	GENERAL AIRPORT	GENERAL AIRPORT	GENERAL AIRPORT	GENERAL AIRPORT
AIRSTRIP	AIRSTRIP	AIRSTRIP	AIRSTRIP	AIRSTRIP	AIRSTRIP
SEAPLANE	SEAPLANE	SEAPLANE	SEAPLANE	SEAPLANE	SEAPLANE
AIRPORT RUNWAY	AIRPORT RUNWAY	AIRPORT RUNWAY	AIRPORT RUNWAY	AIRPORT RUNWAY	AIRPORT RUNWAY
BOUNDARY FEATURES	BOUNDARY FEATURES	BOUNDARY FEATURES	BOUNDARY FEATURES	BOUNDARY FEATURES	BOUNDARY FEATURES
TRIBAL LAND	TRIBAL LAND	TRIBAL LAND	TRIBAL LAND	TRIBAL LAND	TRIBAL LAND
STATE OF MINNESOTA	STATE OF MINNESOTA	STATE OF MINNESOTA	STATE OF MINNESOTA	STATE OF MINNESOTA	STATE OF MINNESOTA
COUNTY	COUNTY	COUNTY	COUNTY	COUNTY	COUNTY
MUNICIPALITY	MUNICIPALITY	MUNICIPALITY	MUNICIPALITY	MUNICIPALITY	MUNICIPALITY
UNORGANIZED TERRITORY	UNORGANIZED TERRITORY	UNORGANIZED TERRITORY	UNORGANIZED TERRITORY	UNORGANIZED TERRITORY	UNORGANIZED TERRITORY
FEDERAL ADJUSTED URBAN AREA (2014)	FEDERAL ADJUSTED URBAN AREA (2014)	FEDERAL ADJUSTED URBAN AREA (2014)	FEDERAL ADJUSTED URBAN AREA (2014)	FEDERAL ADJUSTED URBAN AREA (2014)	FEDERAL ADJUSTED URBAN AREA (2014)
CIVIL TOWNSHIP	CIVIL TOWNSHIP	CIVIL TOWNSHIP	CIVIL TOWNSHIP	CIVIL TOWNSHIP	CIVIL TOWNSHIP
CONGRESSIONAL TOWNSHIP	CONGRESSIONAL TOWNSHIP	CONGRESSIONAL TOWNSHIP	CONGRESSIONAL TOWNSHIP	CONGRESSIONAL TOWNSHIP	CONGRESSIONAL TOWNSHIP
SECTION	SECTION	SECTION	SECTION	SECTION	SECTION
MILITARY	MILITARY	MILITARY	MILITARY	MILITARY	MILITARY
VOYAGEURS NATIONAL PARK	VOYAGEURS NATIONAL PARK	VOYAGEURS NATIONAL PARK	VOYAGEURS NATIONAL PARK	VOYAGEURS NATIONAL PARK	VOYAGEURS NATIONAL PARK
BOUNDARY WATERS CANOE AREA WILDERNESS	BOUNDARY WATERS CANOE AREA WILDERNESS	BOUNDARY WATERS CANOE AREA WILDERNESS	BOUNDARY WATERS CANOE AREA WILDERNESS	BOUNDARY WATERS CANOE AREA WILDERNESS	BOUNDARY WATERS CANOE AREA WILDERNESS
STATE PARK	STATE PARK	STATE PARK	STATE PARK	STATE PARK	STATE PARK
REGIONAL PARK	REGIONAL PARK	REGIONAL PARK	REGIONAL PARK	REGIONAL PARK	REGIONAL PARK
NATIONAL FOREST	NATIONAL FOREST	NATIONAL FOREST	NATIONAL FOREST	NATIONAL FOREST	NATIONAL FOREST
NATIONAL AND STATE FOREST	NATIONAL AND STATE FOREST	NATIONAL AND STATE FOREST	NATIONAL AND STATE FOREST	NATIONAL AND STATE FOREST	NATIONAL AND STATE FOREST
STATE FOREST	STATE FOREST	STATE FOREST	STATE FOREST	STATE FOREST	STATE FOREST
WILDLIFE REFUGUE AREA	WILDLIFE REFUGUE AREA	WILDLIFE REFUGUE AREA	WILDLIFE REFUGUE AREA	WILDLIFE REFUGUE AREA	WILDLIFE REFUGUE AREA
WILDLIFE MANAGEMENT AREA	WILDLIFE MANAGEMENT AREA	WILDLIFE MANAGEMENT AREA	WILDLIFE MANAGEMENT AREA	WILDLIFE MANAGEMENT AREA	WILDLIFE MANAGEMENT AREA
HYDROLOGIC FEATURES	HYDROLOGIC FEATURES	HYDROLOGIC FEATURES	HYDROLOGIC FEATURES	HYDROLOGIC FEATURES	HYDROLOGIC FEATURES
RIVER OR STREAM (PERENNIAL)	RIVER OR STREAM (PERENNIAL)	RIVER OR STREAM (PERENNIAL)	RIVER OR STREAM (PERENNIAL)	RIVER OR STREAM (PERENNIAL)	RIVER OR STREAM (PERENNIAL)
LAKE, POND OR RESERVOIR	LAKE, POND OR RESERVOIR	LAKE, POND OR RESERVOIR	LAKE, POND OR RESERVOIR	LAKE, POND OR RESERVOIR	LAKE, POND OR RESERVOIR
STREAM (INTERMITTENT)	STREAM (INTERMITTENT)	STREAM (INTERMITTENT)	STREAM (INTERMITTENT)	STREAM (INTERMITTENT)	STREAM (INTERMITTENT)
DRAINAGE DITCH	DRAINAGE DITCH	DRAINAGE DITCH	DRAINAGE DITCH	DRAINAGE DITCH	DRAINAGE DITCH
WETLAND	WETLAND	WETLAND	WETLAND	WETLAND	WETLAND
ISLAND OR LAND	ISLAND OR LAND	ISLAND OR LAND	ISLAND OR LAND	ISLAND OR LAND	ISLAND OR LAND
REGIONAL WATERSHED	REGIONAL WATERSHED	REGIONAL WATERSHED	REGIONAL WATERSHED	REGIONAL WATERSHED	REGIONAL WATERSHED
CULTURAL FEATURES	CULTURAL FEATURES	CULTURAL FEATURES	CULTURAL FEATURES	CULTURAL FEATURES	CULTURAL FEATURES
STATE HISTORICAL MARKER	STATE HISTORICAL MARKER	STATE HISTORICAL MARKER	STATE HISTORICAL MARKER	STATE HISTORICAL MARKER	STATE HISTORICAL MARKER
HISTORIC DISTRICT	HISTORIC DISTRICT	HISTORIC DISTRICT	HISTORIC DISTRICT	HISTORIC DISTRICT	HISTORIC DISTRICT
HISTORIC SITE	HISTORIC SITE	HISTORIC SITE	HISTORIC SITE	HISTORIC SITE	HISTORIC SITE
MONUMENT	MONUMENT	MONUMENT	MONUMENT	MONUMENT	MONUMENT

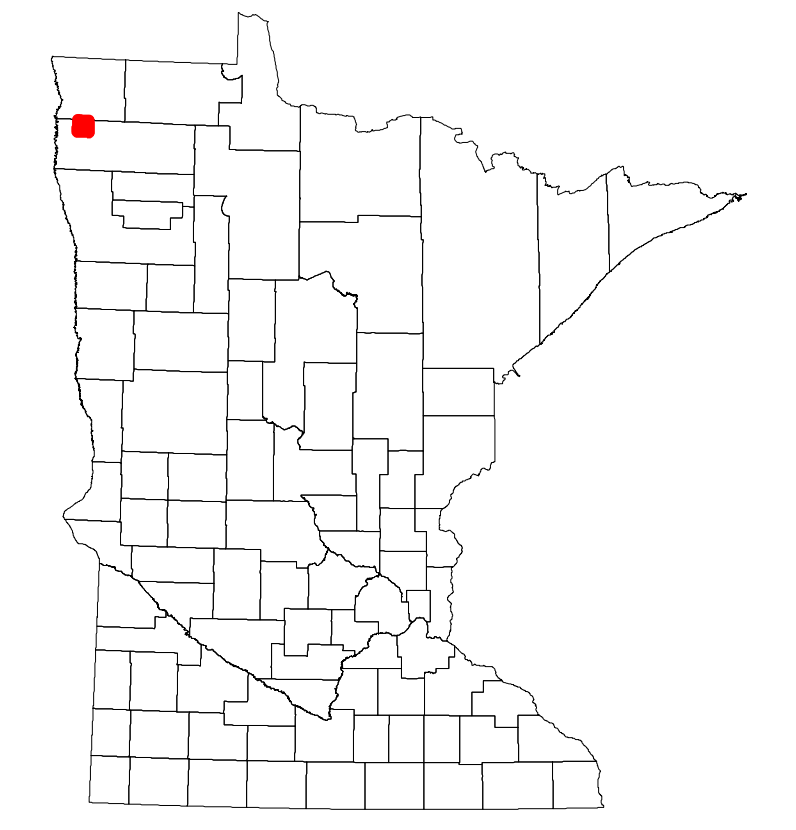

Population (U.S. Census 2010): 24

To request information from this document in an alternative format, call 651-366-4718 or 1-800-657-3774 (Greater Minnesota); 711 or 1-800-627-3529 (Minnesota Relay). You may also send an e-mail to ADarequest.dot@state.mn.us. (Please request at least one week in advance.)