

TOWNSHIP OF GALENA

PREPARED BY THE
MINNESOTA DEPARTMENT OF TRANSPORTATION
OFFICE OF TRANSPORTATION SYSTEM MANAGEMENT

IN COOPERATION WITH
U.S. DEPARTMENT OF TRANSPORTATION
FEDERAL HIGHWAY ADMINISTRATION

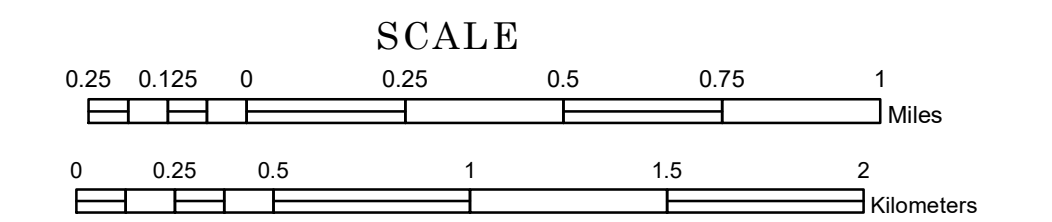

1 in = 1,600 ft

2022

Projection:
Transverse Mercator
NAD 1986
UTM Zone 15

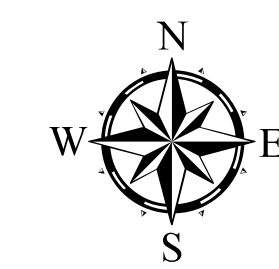

North American Datum
of 1986

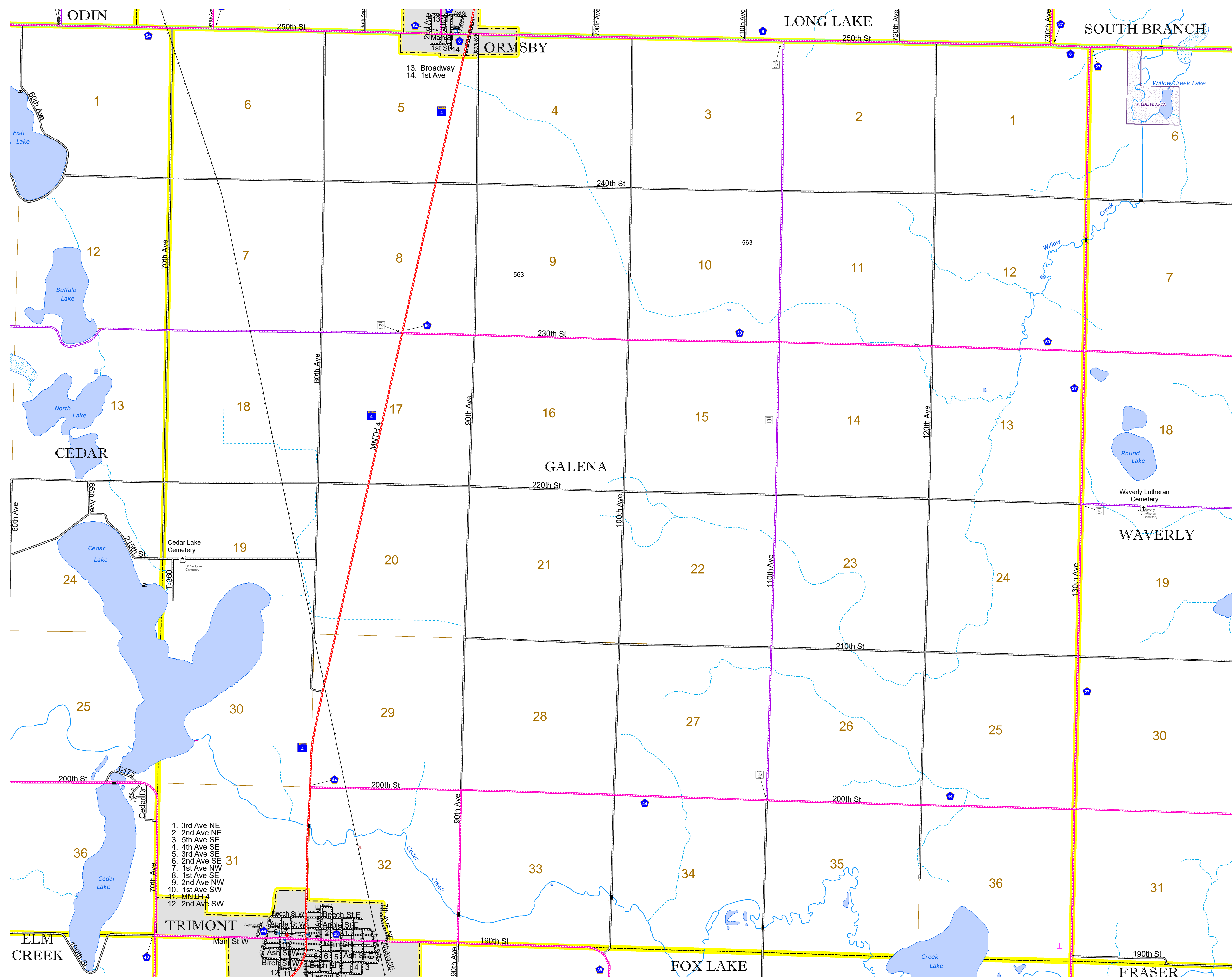

1. 3rd Ave NE
2. 2nd Ave NE
3. 5th Ave SE
4. 4th Ave SE
5. 3rd Ave SE
6. 2nd Ave SE
7. 1st Ave NW
8. 1st Ave SE
9. 2nd Ave NW
10. 1st Ave SW
11. 1st Ave SW
12. 2nd Ave SW

To request information from this document in an alternative format, call 651-366-4718 or 1-800-657-3774 (Greater Minnesota); 711 or 1-800-627-3529 (Minnesota Relay). You may also send an e-mail to ADRequest.dot@state.mn.us. (Please request at least one week in advance.)

Population (U.S. Census 2010): 248