

# TOWNSHIP OF UNION GROVE

PREPARED BY THE  
MINNESOTA DEPARTMENT OF TRANSPORTATION  
OFFICE OF TRANSPORTATION SYSTEM MANAGEMENT

IN COOPERATION WITH  
U.S. DEPARTMENT OF TRANSPORTATION  
FEDERAL HIGHWAY ADMINISTRATION

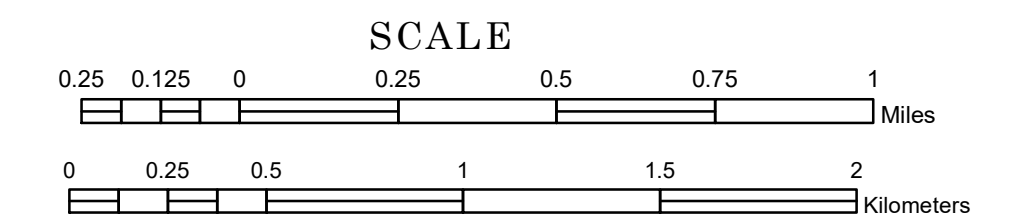

1 in = 1,600 ft

2022



Projection:  
Transverse Mercator  
NAD 1986  
UTM Zone 15

North American Datum  
of 1986

ROAD AND ROADWAY FEATURES	
INTERSTATE	CONCRETE
US HIGHWAY	BITUMINOUS
MN HIGHWAY	GRAVEL
COUNTY STATE AID HIGHWAY	DIRT/UNIMPROVED
COUNTY ROAD	OTHER
TOWNSHIP ROAD	UNKNOWN
UNORGANIZED TERRITORY ROAD	
OTHER ROADS	
Municipal	RAMP OR CONNECTOR
Private	INTERSTATE EXIT
National Monument	AVIATION FEATURES
National Wildlife	COMMERCIAL AIRPORT
State Game	GENERAL AIRPORT
State Park	AIRSTRIP
Preserve	SEAPLANE
	AIRPORT RUNWAY
RAILROAD AND RAILWAY FEATURES	
EMPIRE BUILDER STATION (AMTRAK)	TRIBAL LAND
NORTHSTAR STATION (COMMUTER)	STATE OF MINNESOTA
LIGHT RAIL	COUNTY
BLUE LINE	MUNICIPALITY
GREEN LINE	UNORGANIZED TERRITORY
	FEDERAL ADJUSTED URBAN AREA (2014)
INFRASTRUCTURE FEATURES	
LONG BRIDGE (200' OR GREATER SPAN)	CIVIL TOWNSHIP
MAJOR BRIDGE (20' TO 200' SPAN)	CONGRESSIONAL TOWNSHIP
MINOR BRIDGE (5' TO 20' SPAN)	SECTION
DAM	MILITARY
LOCK AND DAM	VOYAGEURS NATIONAL PARK
	BOUNDARY WATERS CANOE AREA WILDERNESS
CITY CENTERS	
STATE CAPITAL	STATE PARK
COUNTY SEAT	REGIONAL PARK
CITY CENTER	NATIONAL FOREST
UNINCORPORATED COMMUNITY	NATIONAL AND STATE FOREST
	STATE FOREST
PUBLIC SERVICE FEATURES	
MNDOT OFFICE	WILDLIFE REFUGUE AREA
MNDOT TRUCK STATION	WILDLIFE MANAGEMENT AREA
HIGHWAY PATROL DISTRICT OFFICE	HYDROLOGIC FEATURES
STATE TRAVEL INFORMATION CENTER	RIVER OR STREAM (PERENNIAL)
REST AREA (FULL SERVICE)	LAKE, POND OR RESERVOIR
REST AREA (VAULT TOILET)	STREAM (INTERMITTENT)
WAYSIDE (VAULT OR PITY TOILET)	DRAINAGE DITCH
PARK AND RIDE LOT	WETLAND
PORT OF ENTRY	ISLAND OR LAND
PUBLIC ACCESS POINT	REGIONAL WATERSHED
MN STATE COLLEGE AND UNIVERSITY SYSTEM (MNSCU)	
UNIVERSITY OF MN SYSTEM	
FAIRGROUNDS	
CULTURAL FEATURES	
STATE HISTORICAL MARKER	
HISTORIC DISTRICT	
HISTORIC SITE	
MONUMENT	

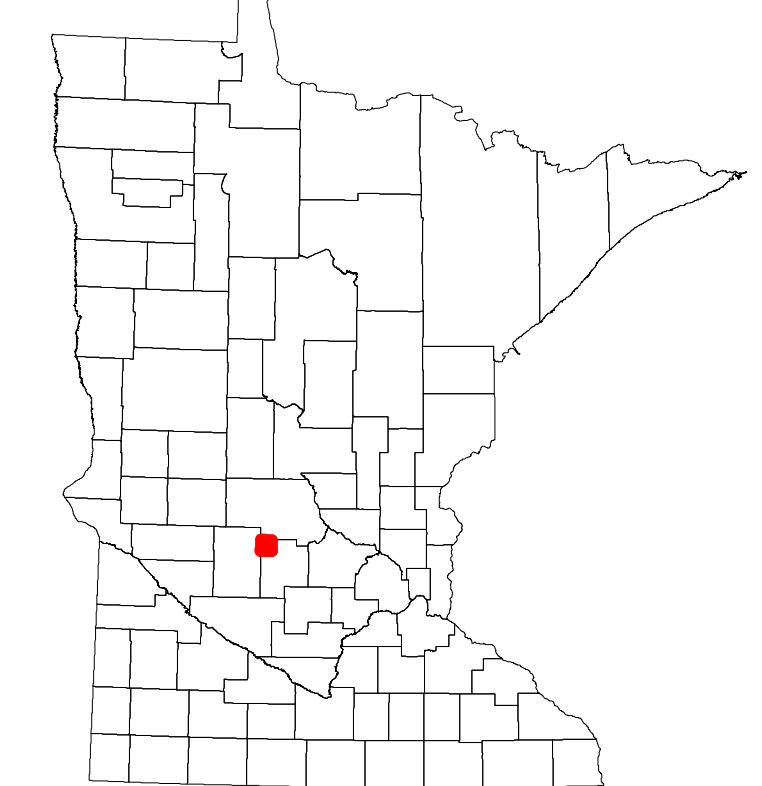

Population (U.S. Census 2010): 633

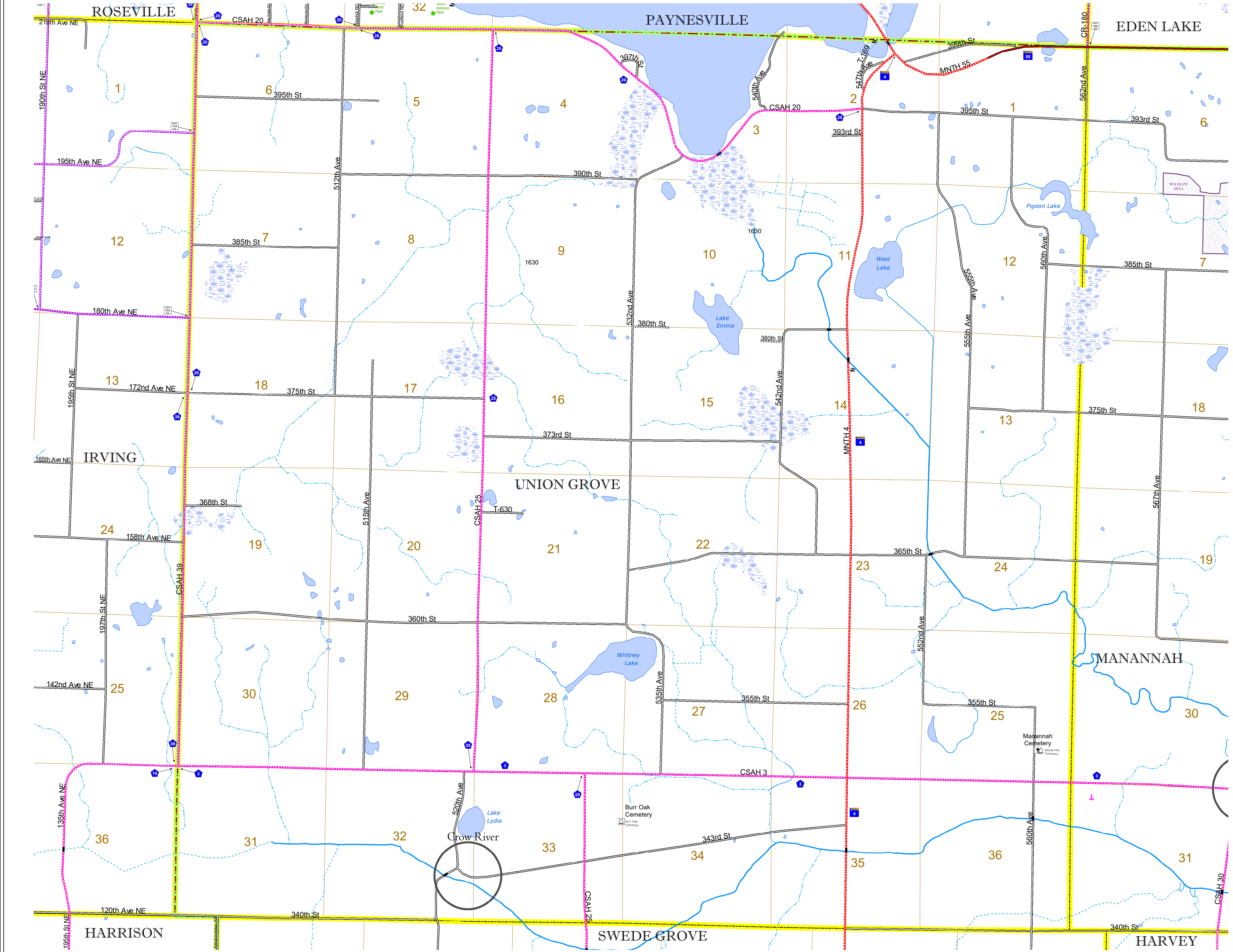

To request information from this document in an alternative format, call 651-366-4718 or 1-800-657-3774 (Greater Minnesota); 711 or 1-800-627-3529 (Minnesota Relay). You may also send an e-mail to ADARquest.dot@state.mn.us. (Please request at least one week in advance.)