

TOWNSHIP OF BELLEVUE

PREPARED BY THE
MINNESOTA DEPARTMENT OF TRANSPORTATION
OFFICE OF TRANSPORTATION SYSTEM MANAGEMENT

IN COOPERATION WITH
U.S. DEPARTMENT OF TRANSPORTATION
FEDERAL HIGHWAY ADMINISTRATION

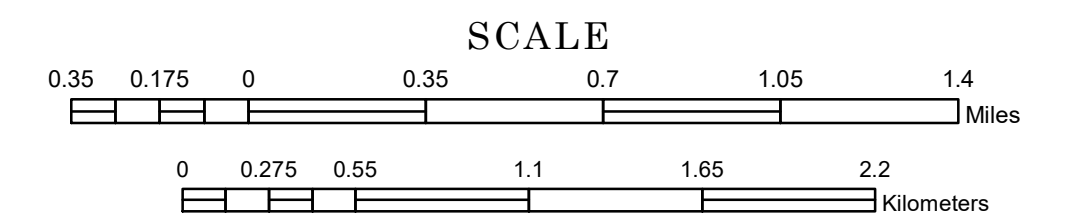

1 in = 2,000 ft

2023

Projection:
Transverse Mercator
NAD 1986
UTM Zone 15

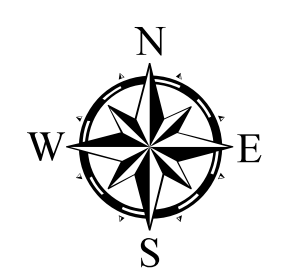

North American Datum
of 1986

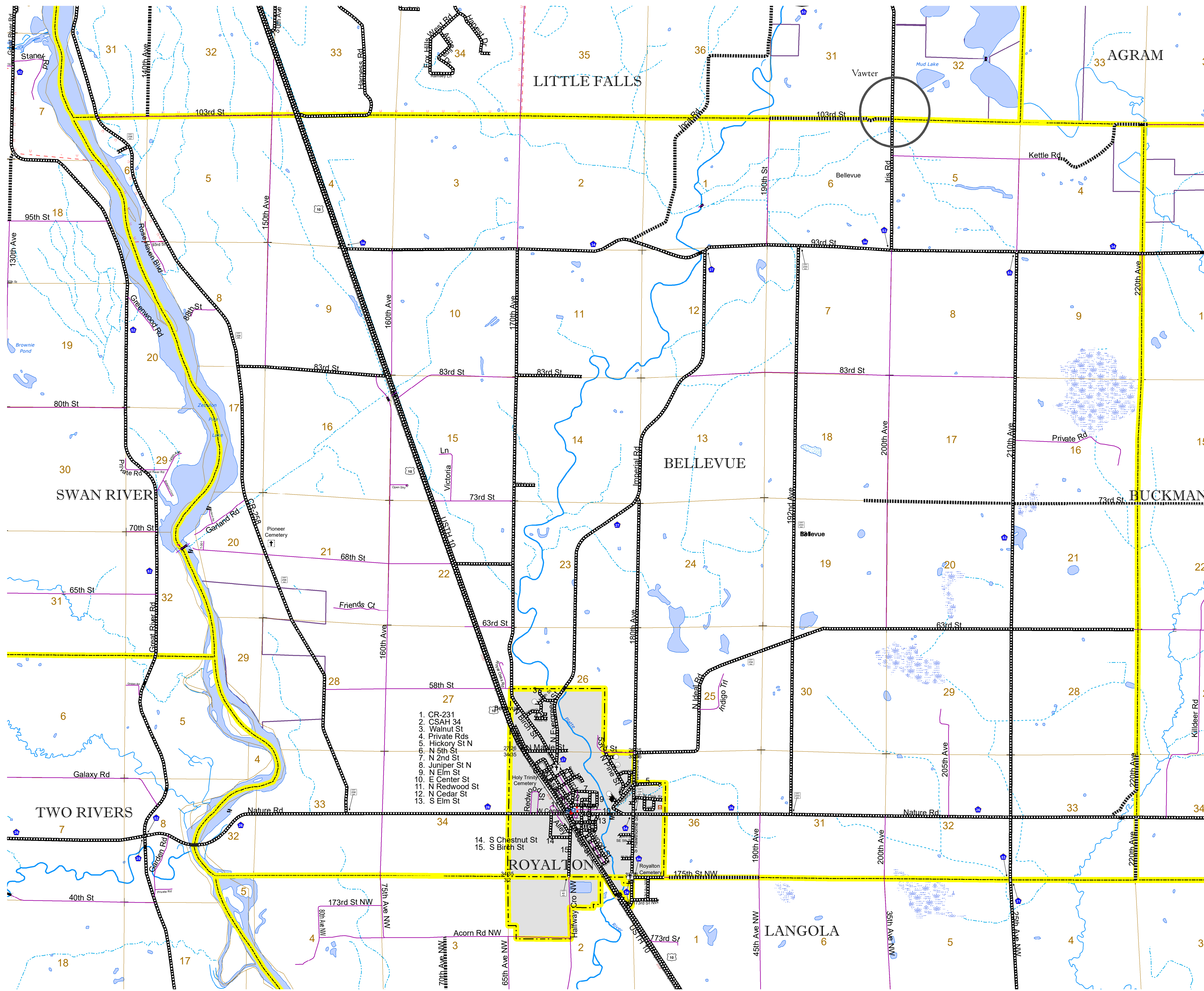

1. CR-231
2. CSAH 34
3. Walnut St
4. Private Rds
5. Hickory St N
6. N 5th St
7. N 2nd St
8. Juniper St N
9. N Elm St
10. E Center St
11. N Redwood St
12. N Cedar St
13. S Elm St
14. S Chestnut St
15. S Birch St

ROAD AND ROADWAY FEATURES	RAILROAD AND RAILWAY FEATURES	AVIATION FEATURES
INTERSTATE	EMPIRE BUILDER STATION (AMTRAK)	COMMERCIAL AIRPORT
US HIGHWAY	NORTHSTAR STATION (COMMUTER)	GENERAL AIRPORT
MN HIGHWAY	LIGHT RAIL	AIRSTRIP
COUNTY STATE AID HIGHWAY	BLUE LINE	SEAPLANE
COUNTY ROAD	GREEN LINE	AIRPORT RUNWAY
TOWNSHIP ROAD	LONG BRIDGE (200' OR GREATER SPAN)	BOUNDARY FEATURES
UNORGANIZED TERRITORY ROAD	MAJOR BRIDGE (20' TO 200' SPAN)	TRIBAL LAND
OTHER ROADS	MINOR BRIDGE (5' TO 20' SPAN)	STATE OF MINNESOTA
Municipal	DAM	COUNTY
Private	LOCK AND DAM	MUNICIPALITY
National Monument	STATE CAPITAL	UNORGANIZED TERRITORY
National Wildlife Refuge	COUNTY SEAT	FEDERAL ADJUSTED URBAN AREA (2014)
State Game Preserve	CITY CENTER	CIVIL TOWNSHIP
State Park	UNINCORPORATED COMMUNITY	CONGRESSIONAL TOWNSHIP
Section	MNDOT OFFICE	SECTION
Section	MNDOT TRUCK STATION	MILITARY
Section	HIGHWAY PATROL DISTRICT OFFICE	VOYAGEURS NATIONAL PARK
Section	STATE TRAVEL INFORMATION CENTER	BOUNDARY WATERS CANOE AREA WILDERNESS
Section	REST AREA (FULL SERVICE)	STATE PARK
Section	REST AREA (VAULT TOILET)	REGIONAL PARK
Section	WAYSIDE (VAULT OR PIT TOILET)	NATIONAL FOREST
Section	PARK AND RIDE LOT	NATIONAL AND STATE FOREST
Section	PORT OF ENTRY	STATE FOREST
Section	PUBLIC ACCESS POINT	NATIONAL TRAIL
Section	MN STATE COLLEGE AND UNIVERSITY SYSTEM (MNSCU)	WILDLIFE REFUGE AREA
Section	UNIVERSITY OF MN SYSTEM	WILDLIFE MANAGEMENT AREA
Section	FAIRGROUNDS	HYDROLOGIC FEATURES
Section	CULTURAL FEATURES	RIVER OR STREAM (PERMANENT)
Section	STATE HISTORICAL MARKER	LAKE, POND OR RESERVOIR
Section	HISTORIC DISTRICT	STREAM (INTERMITTENT)
Section	HISTORIC SITE	DRAINAGE DITCH
Section	MONUMENT	WETLAND
		ISLAND OR LAND
		REGIONAL WATERSHED

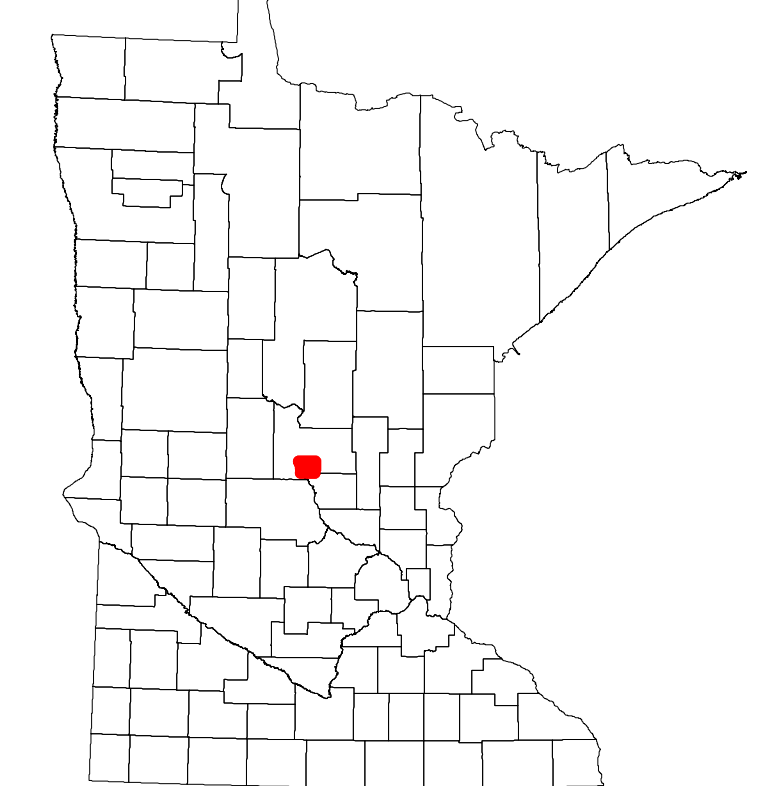

Population (U.S. Census 2010): 1093

To request information from this document in an alternative format, call 651-366-4718 or 1-800-657-3774 (Greater Minnesota); 711 or 1-800-627-3529 (Minnesota Relay). You may also send an e-mail to ADARquest.dot@state.mn.us. (Please request at least one week in advance.)