

TOWNSHIP OF KERRICK

PREPARED BY THE
MINNESOTA DEPARTMENT OF TRANSPORTATION
OFFICE OF TRANSPORTATION SYSTEM MANAGEMENT

IN COOPERATION WITH
U.S. DEPARTMENT OF TRANSPORTATION
FEDERAL HIGHWAY ADMINISTRATION



2022

Projection:
Transverse Mercator
NAD 1986
UTM Zone 15



North American Datum
of 1986

| ROAD AND ROADWAY FEATURES | | RAILROAD AND RAILWAY FEATURES | | AVIATION FEATURES | |
|-----------------------------|----------|--|----------|---------------------------------------|----------|
| INTERSTATE | [Symbol] | EMPIRE BUILDER STATION (AMTRAK) | [Symbol] | COMMERCIAL AIRPORT | [Symbol] |
| US HIGHWAY | [Symbol] | NORTHSTAR STATION (COMMUTER) | [Symbol] | GENERAL AIRPORT | [Symbol] |
| MN HIGHWAY | [Symbol] | LIGHT RAIL | [Symbol] | AIRSTRIP | [Symbol] |
| COUNTY STATE AID HIGHWAY | [Symbol] | BLUE LINE | [Symbol] | SEAPLANE | [Symbol] |
| COUNTY ROAD | [Symbol] | GREEN LINE | [Symbol] | AIRPORT RUNWAY | [Symbol] |
| TOWNSHIP ROAD | [Symbol] | LONG BRIDGE (200' OR GREATER SPAN) | [Symbol] | AIRPORT TAXIWAY | [Symbol] |
| OTHER | [Symbol] | MAJOR BRIDGE (20' TO 200' SPAN) | [Symbol] | TRIAL LAND | [Symbol] |
| UNORGANIZED TERRITORY ROAD | [Symbol] | MINOR BRIDGE (5' TO 20' SPAN) | [Symbol] | STATE OF MINNESOTA | [Symbol] |
| OTHER ROADS | [Symbol] | DAM | [Symbol] | COUNTY | [Symbol] |
| MUNICIPAL | [Symbol] | LOCK AND DAM | [Symbol] | MUNICIPALITY | [Symbol] |
| PRIVATE | [Symbol] | STATE CAPITAL | [Symbol] | UNINCORPORATED TERRITORY | [Symbol] |
| NATIONAL MONUMENT | [Symbol] | CITY CENTER | [Symbol] | FEDERAL ADJUSTED URBAN AREA (2014) | [Symbol] |
| NATIONAL FOREST | [Symbol] | COUNTY SEAT | [Symbol] | CIVIL TOWNSHIP | [Symbol] |
| STATE FOREST | [Symbol] | CITY CENTER | [Symbol] | CONGRESSIONAL TOWNSHIP | [Symbol] |
| STATE PARK | [Symbol] | UNINCORPORATED COMMUNITY | [Symbol] | SECTION | [Symbol] |
| NATIONAL AND STATE FOREST | [Symbol] | MNDOT OFFICE | [Symbol] | MILITARY | [Symbol] |
| STATE FOREST | [Symbol] | MNDOT TRUCK STATION | [Symbol] | VOYAGEURS NATIONAL PARK | [Symbol] |
| WILDLIFE REFUGUE AREA | [Symbol] | HIGHWAY PATROL DISTRICT OFFICE | [Symbol] | BOUNDARY WATERS CANOE AREA WILDERNESS | [Symbol] |
| WILDLIFE MANAGEMENT AREA | [Symbol] | STATE TRAVEL INFORMATION CENTER | [Symbol] | STATE PARK | [Symbol] |
| HYDROLOGIC FEATURES | [Symbol] | REST AREA (FULL SERVICE) | [Symbol] | NATIONAL FOREST | [Symbol] |
| RIVER OR STREAM (PERMANENT) | [Symbol] | REST AREA (VAULT TOILET) | [Symbol] | NATIONAL AND STATE FOREST | [Symbol] |
| LAKE, POND OR RESERVOIR | [Symbol] | WAYSIDE (VAULT OR PITY TOILET) | [Symbol] | STATE FOREST | [Symbol] |
| STREAM (INTERMITTENT) | [Symbol] | PARK AND RIDE LOT | [Symbol] | NATIONAL TRAIL | [Symbol] |
| DRAINAGE DITCH | [Symbol] | PORT OF ENTRY | [Symbol] | WILDLIFE REFUGUE AREA | [Symbol] |
| WETLAND | [Symbol] | PUBLIC ACCESS POINT | [Symbol] | WILDLIFE MANAGEMENT AREA | [Symbol] |
| ISLAND OR LAND | [Symbol] | MN STATE COLLEGE AND UNIVERSITY SYSTEM (MNSCU) | [Symbol] | HYDROLOGIC FEATURES | [Symbol] |
| REGIONAL WATERSHED | [Symbol] | UNIVERSITY OF MN SYSTEM | [Symbol] | RIVER OR STREAM (PERMANENT) | [Symbol] |
| | | FAIRGROUNDS | [Symbol] | LAKE, POND OR RESERVOIR | [Symbol] |
| | | CULTURAL FEATURES | [Symbol] | STREAM (INTERMITTENT) | [Symbol] |
| | | STATE HISTORICAL MARKER | [Symbol] | DRAINAGE DITCH | [Symbol] |
| | | HISTORIC DISTRICT | [Symbol] | WETLAND | [Symbol] |
| | | HISTORIC SITE | [Symbol] | ISLAND OR LAND | [Symbol] |
| | | MONUMENT | [Symbol] | REGIONAL WATERSHED | [Symbol] |

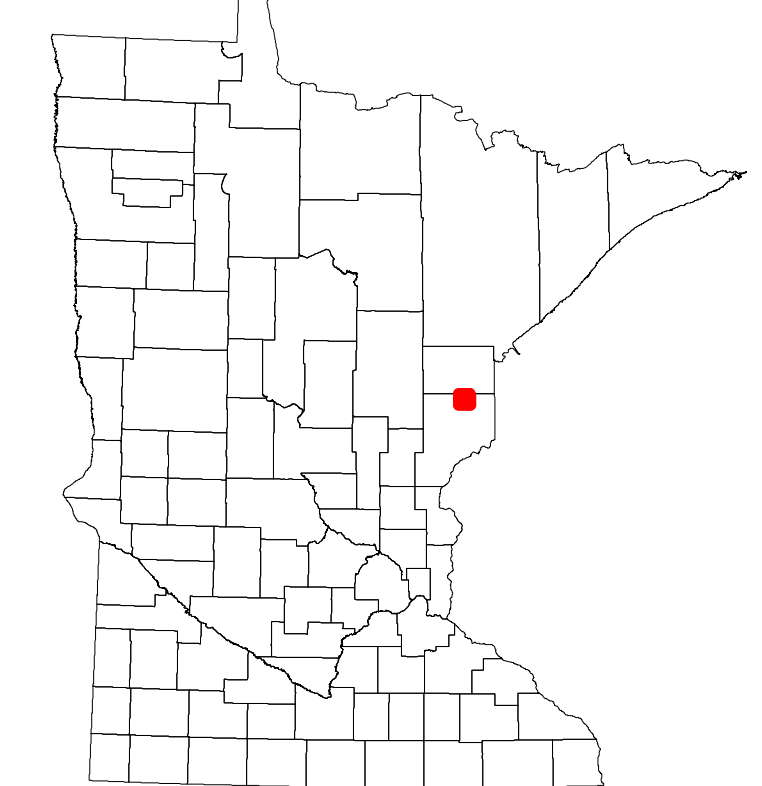

Population (U.S. Census 2010): 325

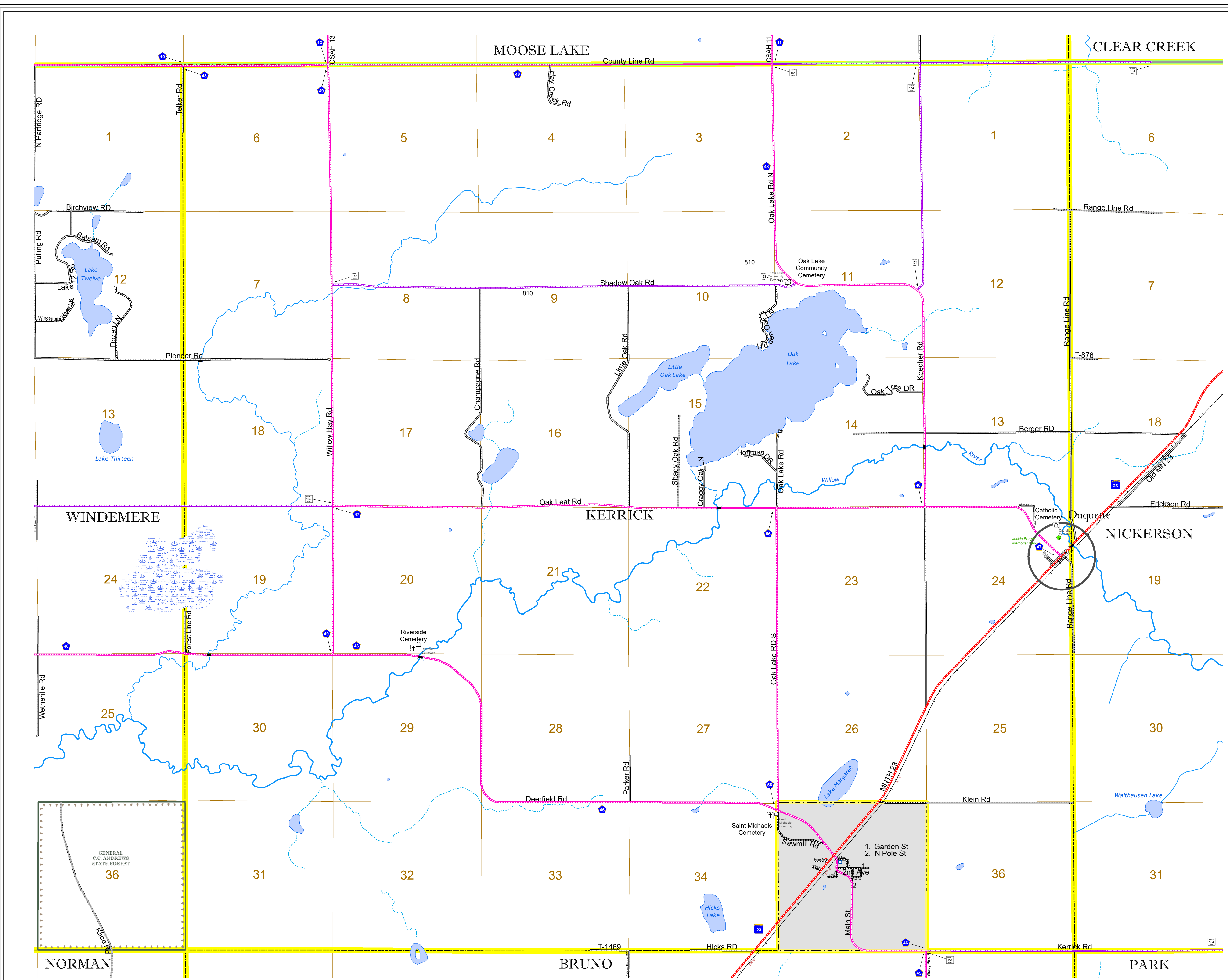

To request information from this document in an alternative format, call 651-366-4718 or 1-800-657-3774 (Greater Minnesota); 711 or 1-800-627-3529 (Minnesota Relay). You may also send an e-mail to ADRequest.dot@state.mn.us. (Please request at least one week in advance.)