

TOWNSHIP OF CHESTER

PREPARED BY THE
MINNESOTA DEPARTMENT OF TRANSPORTATION
OFFICE OF TRANSPORTATION SYSTEM MANAGEMENT

IN COOPERATION WITH
U.S. DEPARTMENT OF TRANSPORTATION
FEDERAL HIGHWAY ADMINISTRATION

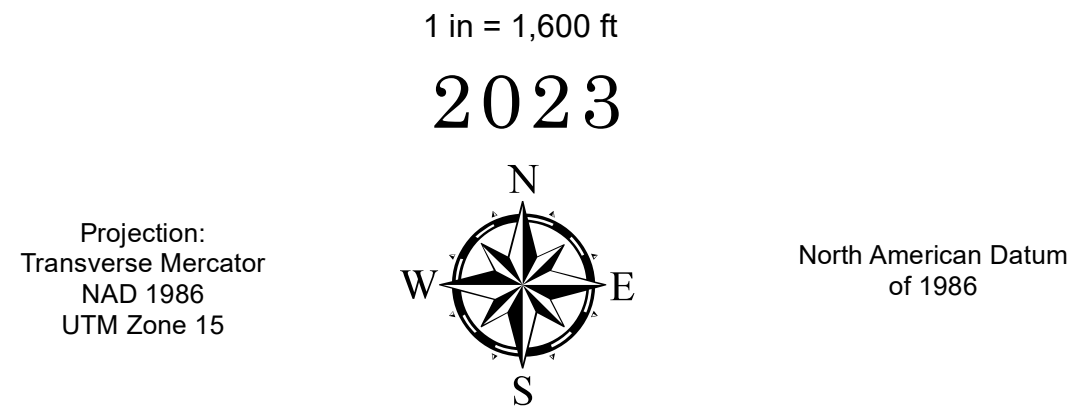
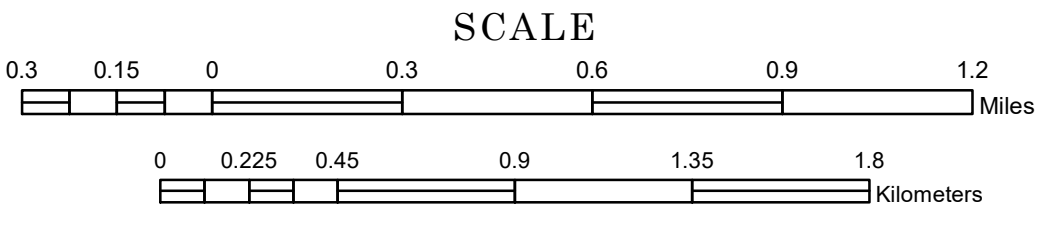

ROAD AND ROADWAY FEATURES		BOUNDARY FEATURES	
INTERSTATE	CONCRETE	TRIBAL LAND	STATE OF MINNESOTA
US HIGHWAY	BITUMINOUS	COUNTY	MUNICIPALITY
MN HIGHWAY	GRAVEL	UNINCORPORATED COMMUNITY	SECTION
COUNTY STATE AID HIGHWAY	DIRT/UNIMPROVED	MILITARY	VOYAGEURS NATIONAL PARK
COUNTY ROAD	OTHER	UNINCORPORATED COMMUNITY	BOUNDARY WATERS CANOE AREA WILDERNESS
TOWNSHIP ROAD	UNKNOWN	UNINCORPORATED COMMUNITY	STATE PARK
UNORGANIZED TERRITORY ROAD		UNINCORPORATED COMMUNITY	REGIONAL PARK
OTHER ROADS		UNINCORPORATED COMMUNITY	NATIONAL FOREST
Municipal		UNINCORPORATED COMMUNITY	NATIONAL AND STATE FOREST
Private		UNINCORPORATED COMMUNITY	STATE FOREST
National Monument		UNINCORPORATED COMMUNITY	NATIONAL TRAIL
National Wildlife Refuge		UNINCORPORATED COMMUNITY	WILDLIFE REFUGUE AREA
State Game Preserve		UNINCORPORATED COMMUNITY	WILDLIFE MANAGEMENT AREA
State Park		UNINCORPORATED COMMUNITY	HYDROLOGIC FEATURES
Present		UNINCORPORATED COMMUNITY	RIVER OR STREAM (PERMANENT)
		UNINCORPORATED COMMUNITY	LAKE, POND OR RESERVOIR
		UNINCORPORATED COMMUNITY	STREAM (INTERMITTENT)
		UNINCORPORATED COMMUNITY	DRAINAGE DITCH
		UNINCORPORATED COMMUNITY	WETLAND
		UNINCORPORATED COMMUNITY	ISLAND OR LAND
		UNINCORPORATED COMMUNITY	REGIONAL WATERSHED

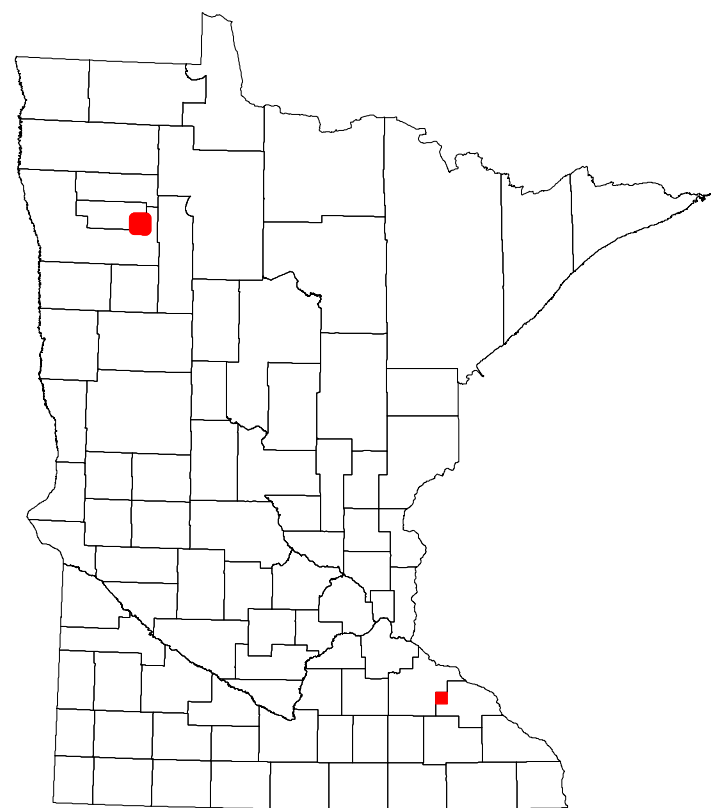

Population (U.S. Census 2010): 75

To request information from this document in an alternative format, call 651-366-4718 or 1-800-657-3774 (Greater Minnesota); 711 or 1-800-627-3529 (Minnesota Relay). You may also send an e-mail to ADARrequest.dot@state.mn.us. (Please request at least one week in advance.)