

TOWNSHIP OF GROVE PARK-TILDEN

PREPARED BY THE
MINNESOTA DEPARTMENT OF TRANSPORTATION
OFFICE OF TRANSPORTATION SYSTEM MANAGEMENT

IN COOPERATION WITH
U.S. DEPARTMENT OF TRANSPORTATION
FEDERAL HIGHWAY ADMINISTRATION

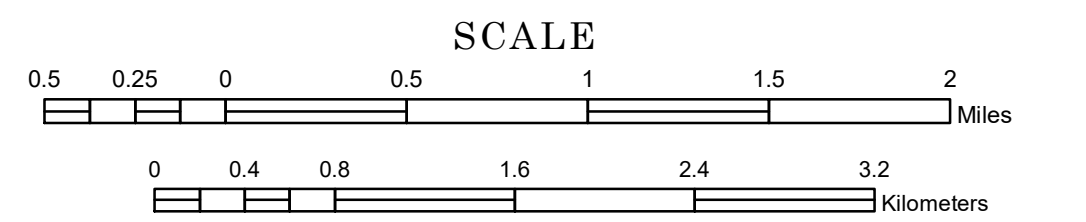

1 in = 2,800 ft

2023

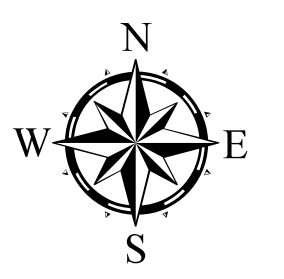

Projection:
Transverse Mercator
NAD 1986
UTM Zone 15

North American Datum
of 1986

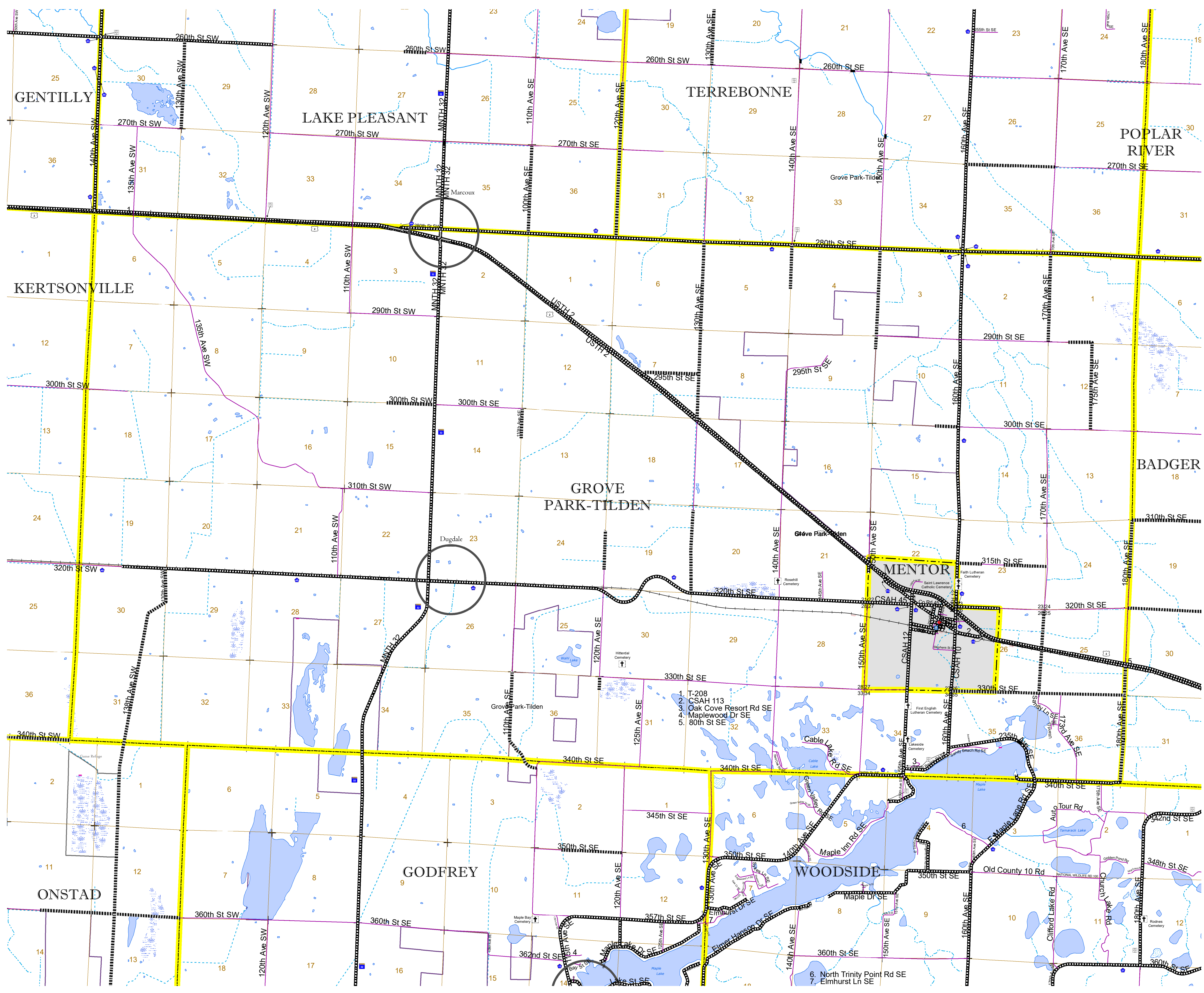

ROAD AND ROADWAY FEATURES		AVIATION FEATURES	
INTERSTATE	CONCRETE	COMMERCIAL AIRPORT	GENERAL AIRPORT
US HIGHWAY	BITUMINOUS	AIRSTRIP	SEAPLANE
MN HIGHWAY	GRAVEL	AIRPORT RUNWAY	BOUNDARY FEATURES
COUNTY STATE AID HIGHWAY	DIRT/UNIMPROVED	TRIAL LAND	STATE OF MINNESOTA
COUNTY ROAD	OTHER	STATE FOREST	COUNTY
TOWNSHIP ROAD	UNKNOWN	NATIONAL FOREST	MUNICIPALITY
UNORGANIZED TERRITORY ROAD		STATE PARK	UNORGANIZED TERRITORY
OTHER ROADS		NATIONAL AND STATE FOREST	FEDERAL ADJUSTED URBAN AREA (2014)
Municipal	RAMP OR CONNECTOR	STATE FOREST	CIVIL TOWNSHIP
Private	INTERSTATE EXIT	WILDLIFE REFUGUE AREA	CONGRESSIONAL TOWNSHIP
National Monument	GREAT RIVER ROAD	WILDLIFE MANAGEMENT AREA	SECTION
National Wildlife Refuge		HYDROLOGIC FEATURES	MILITARY
State Park		RIVER OR STREAM (PERMANENT)	VOYAGEURS NATIONAL PARK
Present		LAKE, POND OR RESERVOIR	BOUNDARY WATERS CANOE AREA WILDERNESS
		STREAM (INTERMITTENT)	STATE PARK
		DRAINAGE DITCH	REGIONAL PARK
		WETLAND	NATIONAL FOREST
		ISLAND OR LAND	NATIONAL AND STATE FOREST
		REGIONAL WATERSHED	STATE FOREST
			NATIONAL TRAIL
			WILDLIFE REFUGUE AREA
			WILDLIFE MANAGEMENT AREA
			HYDROLOGIC FEATURES
			RIVER OR STREAM (PERMANENT)
			LAKE, POND OR RESERVOIR
			STREAM (INTERMITTENT)
			DRAINAGE DITCH
			WETLAND
			ISLAND OR LAND
			REGIONAL WATERSHED

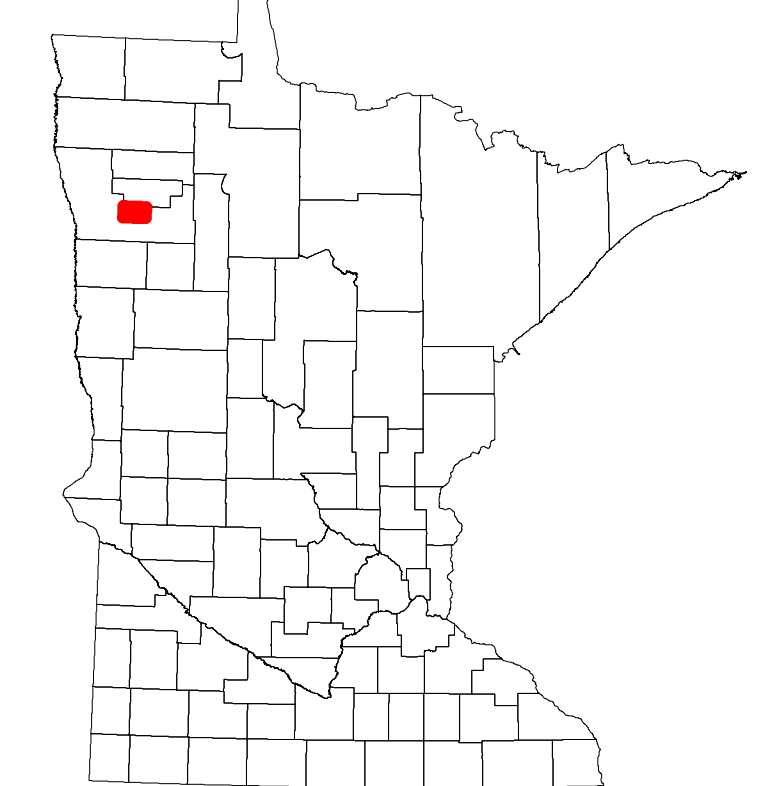

Population (U.S. Census 2010): 282

To request information from this document in an alternative format, call 651-366-4718 or 1-800-657-3774 (Greater Minnesota); 711 or 1-800-627-3529 (Minnesota Relay). You may also send an e-mail to ADAREquest.dot@state.mn.us. (Please request at least one week in advance.)