

TOIVOLA

# TOWNSHIP OF ELMER

PREPARED BY THE  
MINNESOTA DEPARTMENT OF TRANSPORTATION  
OFFICE OF TRANSPORTATION SYSTEM MANAGEMENT

IN COOPERATION WITH  
U.S. DEPARTMENT OF TRANSPORTATION  
FEDERAL HIGHWAY ADMINISTRATION

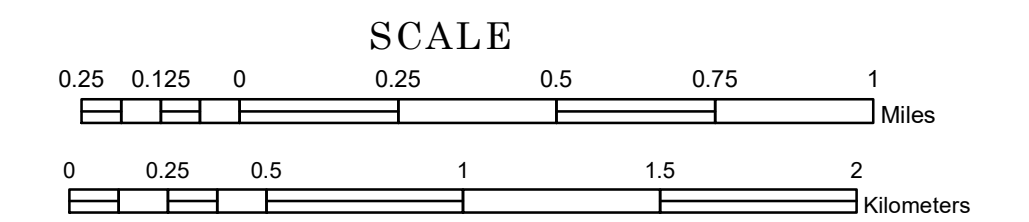

1 in = 1,600 ft

2022

Projection:  
Transverse Mercator  
NAD 1986  
UTM Zone 15

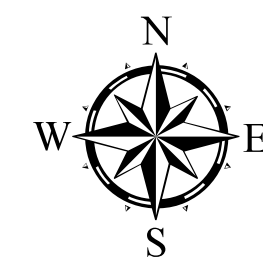

North American Datum  
of 1986

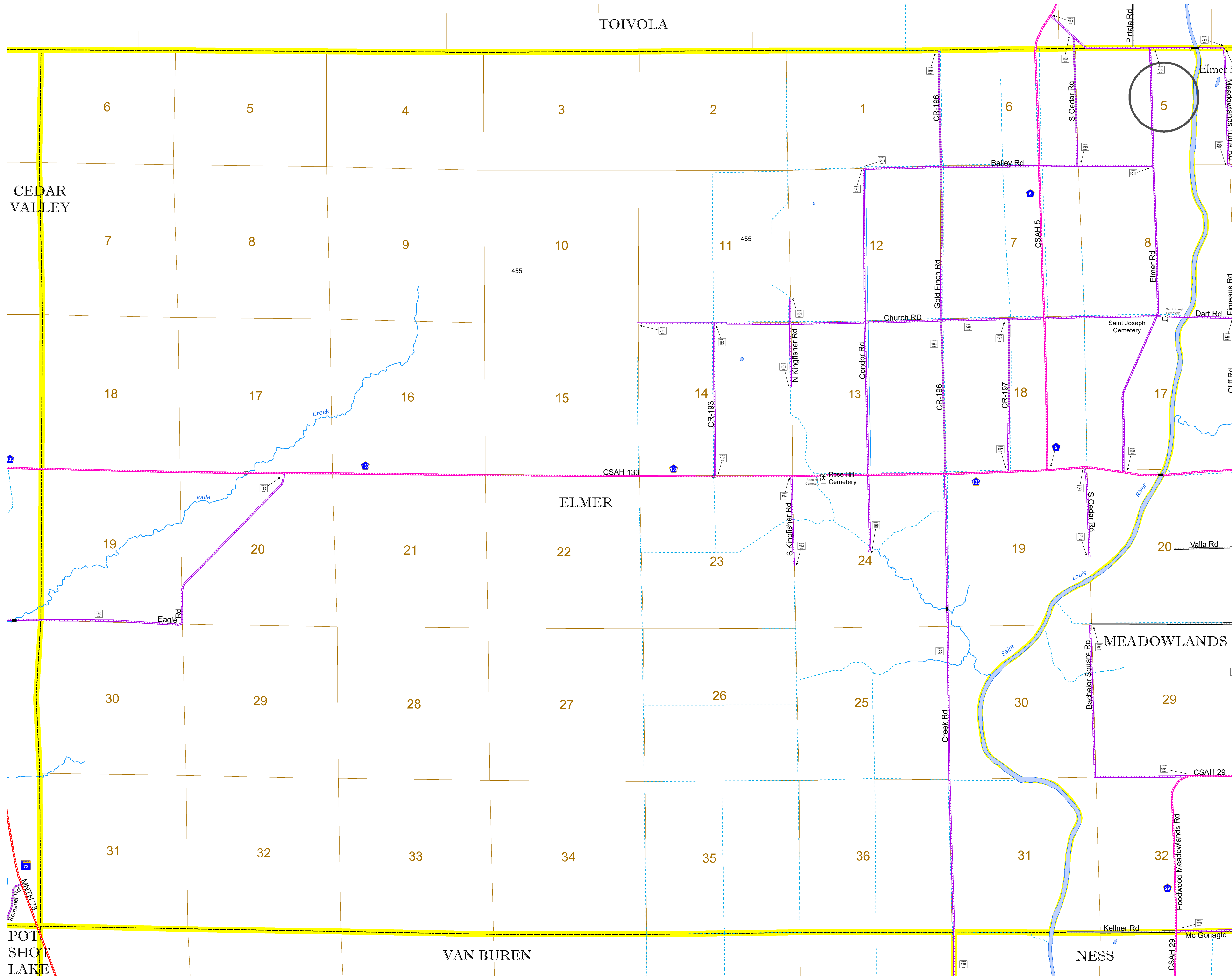

ROAD AND ROADWAY FEATURES		
INTERSTATE	CONCRETE	
US HIGHWAY	BITUMINOUS	
MN HIGHWAY	GRAVEL	
COUNTY STATE AID HIGHWAY	DIRT/UNIMPROVED	
COUNTY ROAD	OTHER	
TOWNSHIP ROAD	UNKNOWN	
UNORGANIZED TERRITORY ROAD		
OTHER ROADS	RAMP OR CONNECTOR	
Municipal	Private	
National Monument	State Forest	
National Park	National Wildlife	
National Cemetery	State Park	
National Shrine	Preserve	
RAILROAD AND RAILWAY FEATURES		
EMPIRE BUILDER STATION (AMTRAK)	COMMERCIAL AIRPORT	
NORTHSTAR STATION (COMMUTER)	GENERAL AIRPORT	
LIGHT RAIL	AIRSTRIP	
BLUE LINE	SEAPLANE	
GREEN LINE	AIRPORT RUNWAY	
INFRASTRUCTURE FEATURES		
LONG BRIDGE (200' OR GREATER SPAN)	TRIAL LAND	
MAJOR BRIDGE (20' TO 200' SPAN)	STATE OF MINNESOTA	
MINOR BRIDGE (5' TO 20' SPAN)	COUNTY	
DAM	MUNICIPALITY	
LOCK AND DAM	UNORGANIZED TERRITORY	
CITY CENTERS		
STATE CAPITAL	CITY CENTER	
COUNTY SEAT	UNINCORPORATED COMMUNITY	
PUBLIC SERVICE FEATURES		
MNDOT OFFICE	STATE PARK	
MNDOT TRUCK STATION	NATIONAL FOREST	
HIGHWAY PATROL DISTRICT OFFICE	NATIONAL AND STATE FOREST	
STATE TRAVEL INFORMATION CENTER	STATE FOREST	
REST AREA (FULL SERVICE)	NATIONAL TRAIL	
REST AREA (VAULT TOILET)	WILDLIFE REFUGES AREA	
WAYSIDE (VAULT OR PITY TOILET)	WILDLIFE MANAGEMENT AREA	
PARK AND RIDE LOT	UNIVERSITY OF MN SYSTEM	
PORT OF ENTRY	FAIRGROUNDS	
PUBLIC ACCESS POINT	HYDROLOGIC FEATURES	
MN STATE COLLEGE AND UNIVERSITY SYSTEM (MNSCU)	LAKE, POND OR RESERVOIR	
UNIVERSITY OF MN SYSTEM	STREAM (PERMANENT)	
CULTURAL FEATURES		
STATE HISTORICAL MARKER	DRAINAGE DITCH	
HISTORIC DISTRICT	WETLAND	
HISTORIC SITE	ISLAND OR LAND	
MONUMENT	REGIONAL WATERSHED	

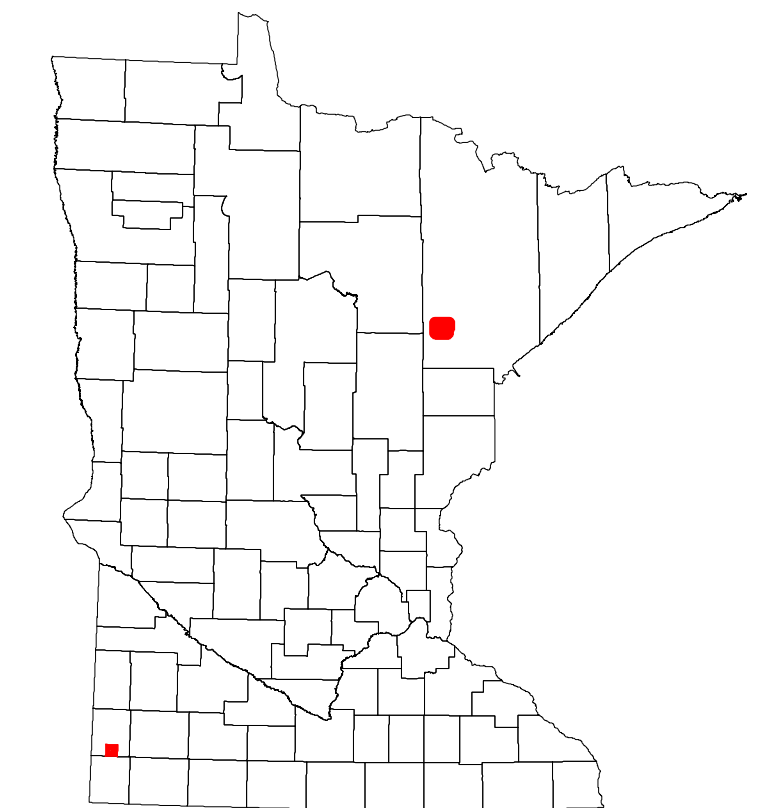

Population (U.S. Census 2010): 151

To request information from this document in an alternative format, call 651-366-4718 or 1-800-657-3774 (Greater Minnesota); 711 or 1-800-627-3529 (Minnesota Relay). You may also send an e-mail to ADAREquest.dot@state.mn.us. (Please request at least one week in advance.)