

TOWNSHIP OF LINDEN GROVE

PREPARED BY THE
MINNESOTA DEPARTMENT OF TRANSPORTATION
OFFICE OF TRANSPORTATION SYSTEM MANAGEMENT

IN COOPERATION WITH
U.S. DEPARTMENT OF TRANSPORTATION
FEDERAL HIGHWAY ADMINISTRATION



1 in = 1,600 ft

2022

Projection:
Transverse Mercator
NAD 1986
UTM Zone 15

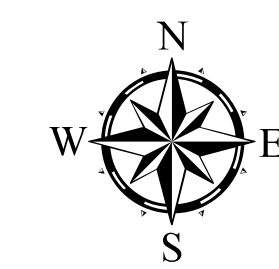

North American Datum
of 1986

ROAD AND ROADWAY FEATURES		BOUNDARY FEATURES	
INTERSTATE	CONCRETE	TRIBAL LAND	STATE OF MINNESOTA
US HIGHWAY	BITUMINOUS	COUNTY	MUNICIPALITY
MN HIGHWAY	GRAVEL	UNINCORPORATED TOWNSHIP	CIVIL TOWNSHIP
COUNTY STATE AID HIGHWAY	DIRT/UNIMPROVED	FEDERAL ADJUSTED URBAN AREA (2014)	CONGRESSIONAL TOWNSHIP
COUNTY ROAD	OTHER	CITY CENTER	SECTION
TOWNSHIP ROAD	UNKNOWN	CITY CENTER	MILITARY
UNORGANIZED TERRITORY ROAD		CITY CENTER	VOYAGEURS NATIONAL PARK
OTHER ROADS		CITY CENTER	BOUNDARY WATERS CANOE AREA WILDERNESS
Municipal	RAMP OR CONNECTOR	CITY CENTER	STATE PARK
Private	INTERSTATE EXIT	CITY CENTER	REGIONAL PARK
National Monument		CITY CENTER	NATIONAL FOREST
National Park		CITY CENTER	NATIONAL AND STATE FOREST
National Wildlife Refuge		CITY CENTER	STATE FOREST
State Park		CITY CENTER	WILDLIFE REFUGUE AREA
Preserve		CITY CENTER	WILDLIFE MANAGEMENT AREA
		CITY CENTER	HYDROLOGIC FEATURES
		CITY CENTER	RIVER OR STREAM (PERENNIAL)
		CITY CENTER	LAKE, POND OR RESERVOIR
		CITY CENTER	STREAM (INTERMITTENT)
		CITY CENTER	DRAINAGE DITCH
		CITY CENTER	WETLAND
		CITY CENTER	ISLAND OR LAND
		CITY CENTER	REGIONAL WATERSHED

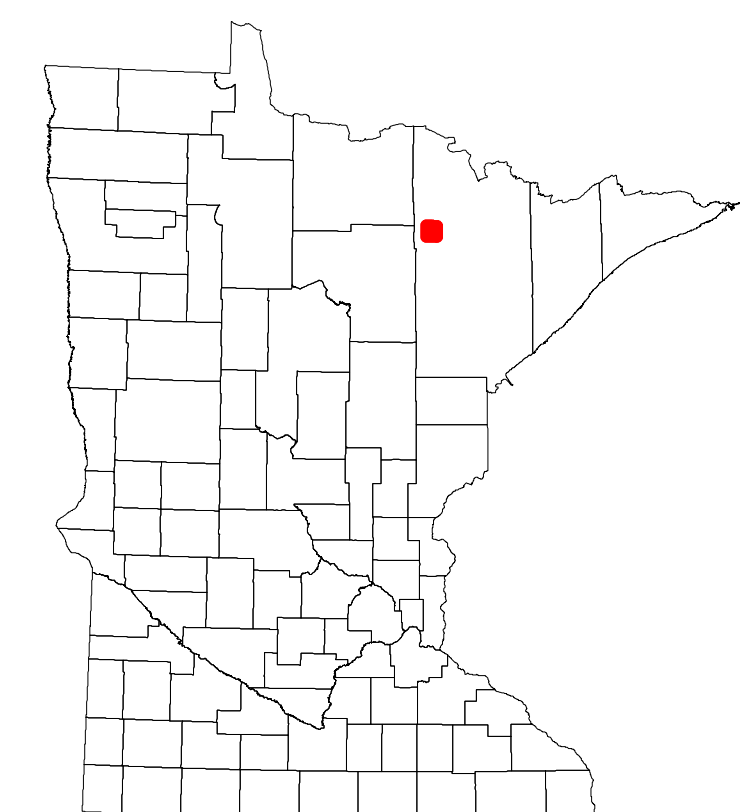

Population (U.S. Census 2010): 145

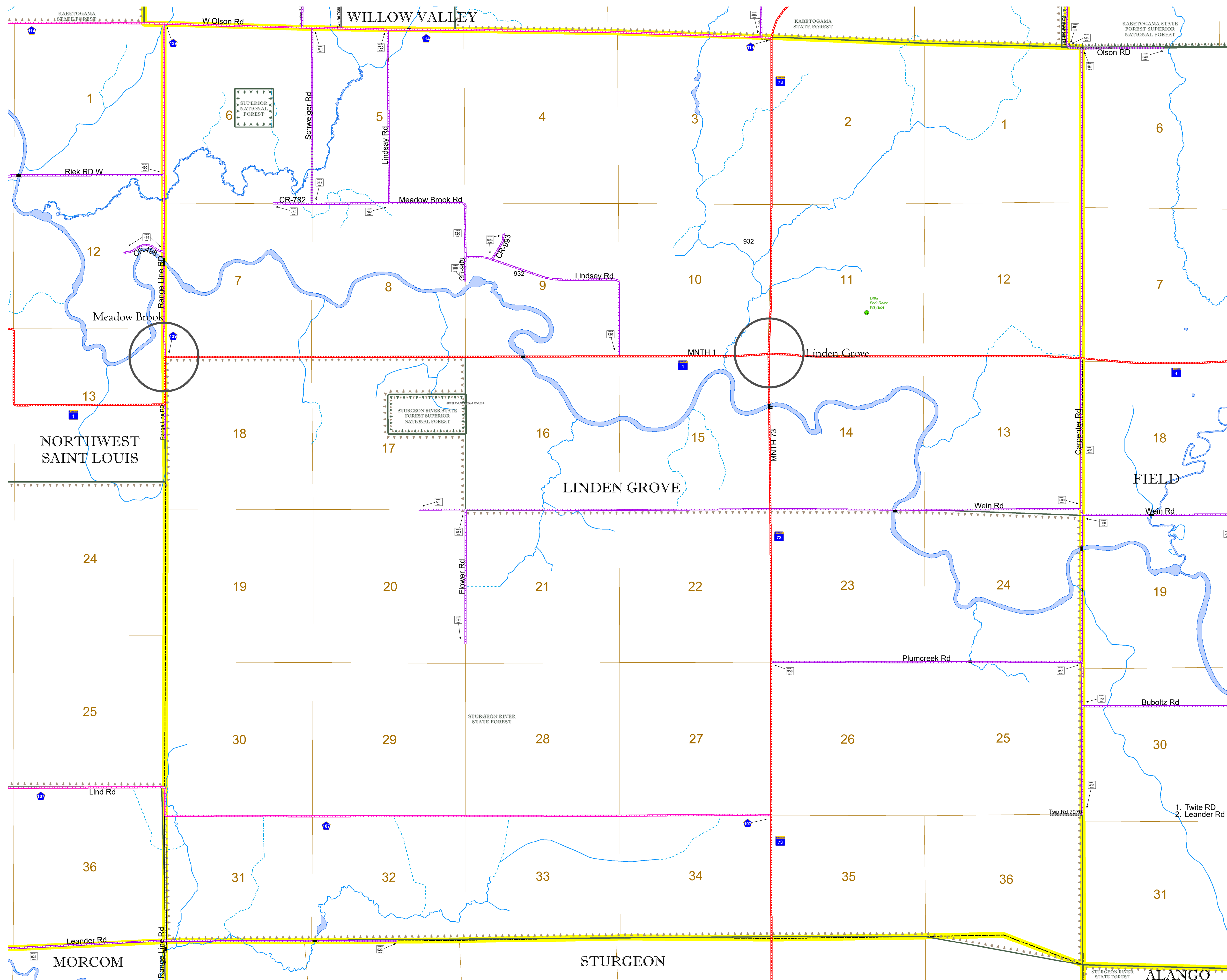

To request information from this document in an alternative format, call 651-366-4718 or 1-800-657-3774 (Greater Minnesota); 711 or 1-800-627-3529 (Minnesota Relay). You may also send an e-mail to ADArequest.dot@state.mn.us. (Please request at least one week in advance.)