

TOWNSHIP OF DOLLYMOUNT

PREPARED BY THE
MINNESOTA DEPARTMENT OF TRANSPORTATION
OFFICE OF TRANSPORTATION SYSTEM MANAGEMENT

IN COOPERATION WITH
U.S. DEPARTMENT OF TRANSPORTATION
FEDERAL HIGHWAY ADMINISTRATION

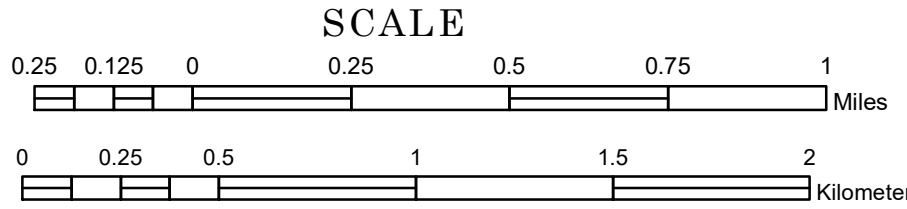

1 in = 1,600 ft
2022

Projection:
Transverse Mercator
NAD 1986
UTM Zone 15

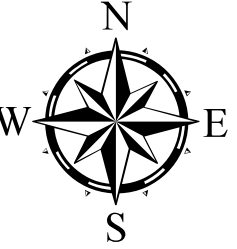

North American Datum
of 1986

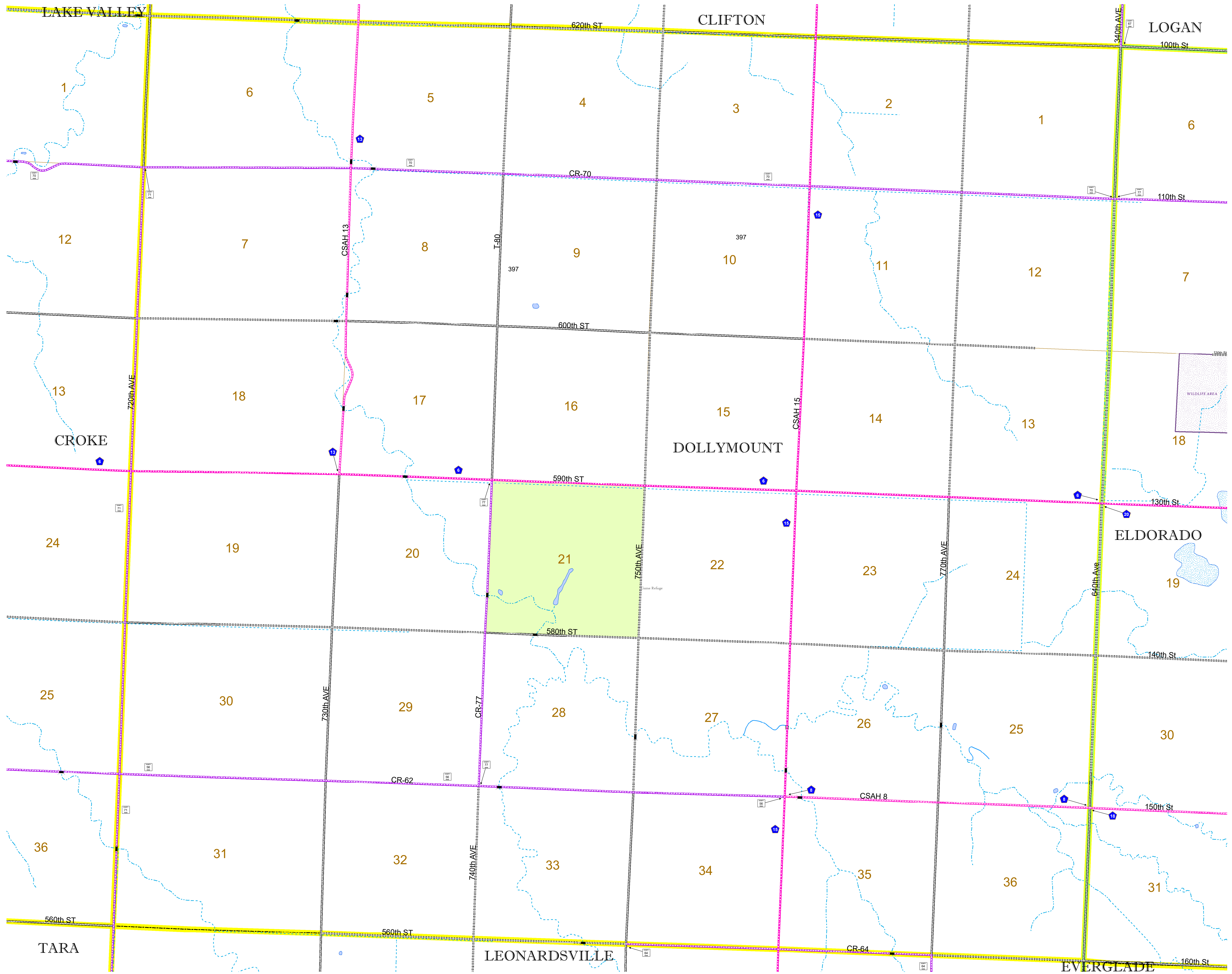

ROAD AND ROADWAY FEATURES		AVIATION FEATURES	
INTERSTATE		CONCRETE	
US HIGHWAY		BITUMINOUS	
MN HIGHWAY		GRAVEL	
COUNTY STATE AID HIGHWAY		DIRT/UNIMPROVED	
COUNTY ROAD		OTHER	
TOWNSHIP ROAD		UNKNOWN	
UNORGANIZED TERRITORY ROAD		RAMP OR CONNECTOR	
OTHER ROADS		INTERSTATE EXIT	
MUNICIPAL		GREAT RIVER ROAD	
PRIVATE		COMMERCIAL AIRPORT	
NATIONAL MONUMENT		GENERAL AIRPORT	
STATE FOREST		AIRSTRIP	
NATIONAL SERVICE		SEAPLANE	
NATIONAL FOREST		AIRPORT RUNWAY	
STATE PARK		BOUNDARY FEATURES	
MILITARY		TRIBAL LAND	
RAILROAD AND RAILWAY FEATURES		STATE OF MINNESOTA	
EMPIRE BUILDER STATION (AMTRAK)		COUNTY	
NORTHSTAR STATION (COMMUTER)		MUNICIPALITY	
LIGHT RAIL		UNORGANIZED TERRITORY	
BLUE LINE		FEDERAL ADJUSTED URBAN AREA (2014)	
GREEN LINE		CIVIL TOWNSHIP	
INFRASTRUCTURE FEATURES		CONGRESSIONAL TOWNSHIP	
LONG BRIDGE (200' OR GREATER SPAN)		SECTION	
MAJOR BRIDGE (20' TO 200' SPAN)		MILITARY	
MINOR BRIDGE (5' TO 20' SPAN)		VOYAGEURS NATIONAL PARK	
LOCK AND DAM		BOUNDARY WATERS CANOE AREA WILDERNESS	
CITY CENTERS		STATE PARK	
STATE CAPITAL		REGIONAL PARK	
COUNTY SEAT		NATIONAL FOREST	
CITY CENTER		NATIONAL AND STATE FOREST	
UNINCORPORATED COMMUNITY		STATE FOREST	
PUBLIC SERVICE FEATURES		WILDLIFE REFUGUE AREA	
MNDOT OFFICE		WILDLIFE MANAGEMENT AREA	
MNDOT TRUCK STATION		HYDROLOGIC FEATURES	
HIGHWAY PATROL DISTRICT OFFICE		RIVER OR STREAM (PERMANENT)	
STATE TRAVEL INFORMATION CENTER		LAKE, POND OR RESERVOIR	
REST AREA (FULL SERVICE)		STREAM (INTERMITTENT)	
REST AREA (VAULT TOILET)		DRAINAGE DITCH	
WAYSIDE (VAULT OR PIT TOILET)		WETLAND	
PARK AND RIDE LOT		ISLAND OR LAND	
PORT OF ENTRY		REGIONAL WATERSHED	
PUBLIC ACCESS POINT		CULTURAL FEATURES	
MN STATE COLLEGE AND UNIVERSITY SYSTEM (MNSCU)		STATE HISTORICAL MARKER	
UNIVERSITY OF MN SYSTEM		HISTORIC DISTRICT	
FAIRGROUNDS		HISTORIC SITE	
		MONUMENT	

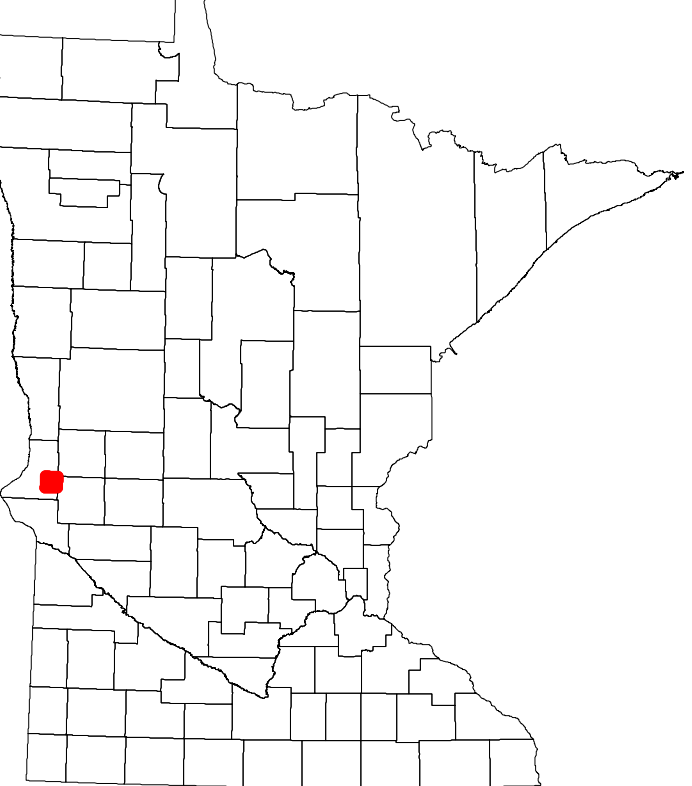

Population (U.S. Census 2010): 77

To request information from this document in an alternative format, call 651-366-4718 or 1-800-657-3774 (Greater Minnesota); 711 or 1-800-627-3529 (Minnesota Relay). You may also send an e-mail to ADARquest.dot@state.mn.us. (Please request at least one week in advance.)